

EMT Straps

Type 15 & Type THTW

Steel Straps

Feature:

- Snap type-double ribbed

Material/Finish:
Steel/Zinc Plated

Third Party Certification:



CSA Certified: 104691

Applicable Third Party Standards:
CSA Standard: C22.2 No. 18

ONE HOLE					
Trade Size (inches)	Catalog Number	Dimensions in Inches			Bolt Size
		A	B	C	
1/2	15-50S	1 1/4	7/8	9/16	1/4
3/4	15-75S	1 3/8	1 1/16	5/8	1/4
1	15-100S	1 5/8	1 1/4	3/4	1/4
1 1/4	15-125S	2	1 1/2	7/8	5/16
1 1/2	15-150S	2 1/8	1 11/16	1	3/8
2	15-200S	2 5/8	2	1 1/8	7/16
2 1/2	14-250S	4 3/8	2 5/8	1 1/4	1/2
3	14-300S	4 3/4	3	1 1/4	1/2
3 1/2	14-350S	5 3/16	3 9/16	1 1/2	5/8
4	14-400S	5 7/16	3 15/16	1 1/2	5/8

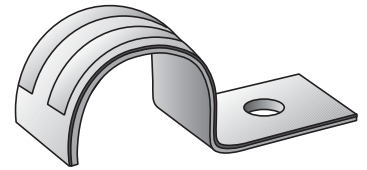

Type 15

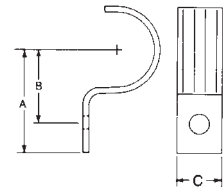

TWO HOLE					
Trade Size (inches)	Catalog Number	Dimensions in Inches			Bolt Size
		A	B	C	
1/2	THTW-50S	1 19/32	2 1/8	5/8	3/16
3/4	THTW-75S	1 23/32	2 1/4	5/8	3/16
1	THTW-100S	2 5/32	2 7/8	23/32	1/4
1 1/4	THTW-125S	2 25/32	3 1/2	23/32	1/4
1 1/2	THTW-150S	3 5/32	3 3/4	23/32	1/4
2	THTW-200S	3 13/16	4 15/32	23/32	1/4
2 1/2	THR-250S	4 11/16	5 23/32	1	5/16
3	THR-300S	5 11/16	6 3/4	1	5/16
3 1/2	THR-350S	6 5/16	7 3/16	1	5/16
4	THR-400S	6 27/32	7 13/16	1	5/16



Type THTW

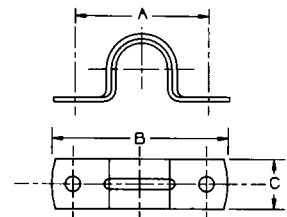

Type 333G

EMT Nail Straps

Material:

Malleable Iron

Finish:

Mechanical Galvanized

Trade Size (inches)	Catalog Number	Dimensions in Inches	
		Nail Length	Nominal Thickness
1/2	333G	2 3/16	3/16
3/4	334G	2 1/2	3/16
1	335G	2 7/8	3/16

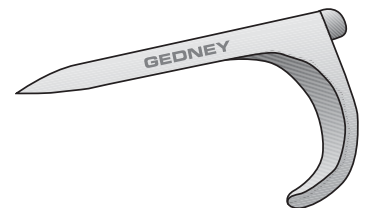

Type 333G