



# Core & Coil (71A) HPS ~LT~ 200W

## CORE & COIL HID 71A7801001D

The basic ballast is the open core and coil which is most often used as a component within a lighting luminaire. The core and coil also forms the nucleus of Philips Advance's five other ballast configurations.

### Product data

| General Information                |                |
|------------------------------------|----------------|
| ANSI Code                          | S68            |
| Lamp Type                          | 50W HPS        |
| Number Of Lamps                    | 1 piece/unit   |
| Circuit Type                       | HX-HPF         |
| Ballast Type                       | Magnetic HID   |
| Base Model                         | 71A7801        |
| Core Size                          | 3 X 4 (2 coil) |
| Suitable For Outdoor Use           | Yes            |
| Ignitor Catalog Number             | LI551-H4       |
| Ignitor Temperature Rating         | 105°C          |
| Capacitor Value                    | 5 MFD          |
| Capacitor Catalog Number           | 7C050L30RA     |
| Capacitor Requirements             | 280V           |
| Capacitor Temperature Rating       | 105°C          |
| Capacitor Diameter/Oval Dimensions | 1.25 in        |
| Capacitor Height                   | 2.25 in        |
| Automatic Restart                  | No             |

| Operating and Electrical        |                     |
|---------------------------------|---------------------|
| Input Voltage                   | 120/277 V           |
| Input Frequency                 | 60 Hz               |
| Power (Rated) (Nom)             | 50 W                |
| Input Current (Open Circuit)    | 1/0.45 A            |
| Input Current (Starting)        | 0.65/0.3 A          |
| Input Current (Short Circuit)   | 0.6-0.8/0.25-0.35 A |
| Secondary Short Circuit Current | 1.3-1.9 A           |
| Constant Wattage Deviation      | Within Trapezoid    |
| Ballast Factor (Nom)            | 1                   |
| Power Factor (Nom)              | 0.90                |
| Open Circuit Voltage            | 125 V               |
| Input Current (Nom)             | 0.61/0.26 A A       |
| Input Power (Nom)               | 66 W                |
| Rated Lamp Power                | 50W W               |

| Wiring               |          |
|----------------------|----------|
| Wire Striplength     | 0.5 mm   |
| Wire Length By Color | 12"      |
| Wire Type            | Stranded |

## Core & Coil (71A) HPS ~LT~ 200W

|                                         |       |
|-----------------------------------------|-------|
| Remote Wiring Configuration Allowed     | Yes   |
| Max Ballast-Lamp Distance Remote Wiring | 2'    |
| Recommended Fuse Value                  | 3/1 A |

### Approval and Application

|                                   |                                    |
|-----------------------------------|------------------------------------|
| Open Circuit Voltage Test (Volts) | 115-135 V                          |
| Approval Marks                    | ULR CSA certificate RoHS Compliant |
| Temperature Marking               | A/A                                |
| UL Recognized                     | Yes                                |
| Hipot Test (1 Minute)             | 2000 V                             |
| Hipot Test (2 Seconds)            | 2500 V                             |
| UL Insulation Class               | H(180°C)                           |

|                     |       |
|---------------------|-------|
| UL Temperature Code | 1029A |
|---------------------|-------|

### Product Data

|                                 |                             |
|---------------------------------|-----------------------------|
| Order product name              | CORE & COIL HID 71A7801001D |
| EAN/UPC - Product               | 781087081327                |
| Order code                      | 913700537609                |
| Numerator - Quantity Per Pack   | 1                           |
| Numerator - Packs per outer box | 1                           |
| Material Nr. (12NC)             | 913700537609                |
| Net Weight (Piece)              | 2.110 kg                    |

### Dimensional drawing

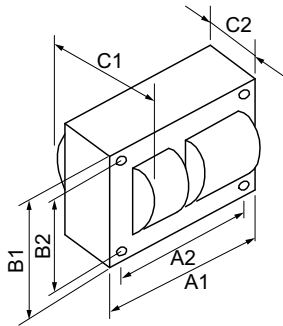

HPS BAL 50W S68 120/277V KIT

| Product                     | C1     | C2   | A1     | A2     | B1     | B2     |
|-----------------------------|--------|------|--------|--------|--------|--------|
| CORE & COIL HID 71A7801001D | 2.2 in | 1 in | 3.9 in | 3.5 in | 2.8 in | 2.4 in |

