

# Core & Coil (71A) MH ~LT~ 175W

## CORE & COIL HID 71A5340500DT

The basic ballast is the open core and coil which is most often used as a component within a lighting luminaire. The core and coil also forms the nucleus of Philips Advance's five other ballast configurations.

### Product data

| General Information                |                |
|------------------------------------|----------------|
| ANSI Code                          | M90-M140       |
| Lamp Type                          | 100 MH         |
| Number Of Lamps                    | 1 piece/unit   |
| Circuit Type                       | HX-HPF         |
| Ballast Type                       | Magnetic HID   |
| Base Model                         | 71A5340T       |
| Core Size                          | 3 X 4 (2 coil) |
| Suitable For Outdoor Use           | Yes            |
| Ignitor Catalog Number             | LI533-H4       |
| Ignitor Temperature Rating         | 105°C          |
| Capacitor Value                    | 10 MFD         |
| Capacitor Catalog Number           | 7C100M30RA     |
| Capacitor Requirements             | 300V           |
| Capacitor Temperature Rating       | 105°C          |
| Capacitor Diameter/Oval Dimensions | 1.65 in        |
| Capacitor Height                   | 2.75 in        |
| Automatic Restart                  | No             |

| Operating and Electrical        |             |
|---------------------------------|-------------|
| Input Voltage                   | 480 V       |
| Input Frequency                 | 60 Hz       |
| Power (Rated) (Nom)             | 100 W       |
| Input Current (Open Circuit)    | 0.55 A      |
| Input Current (Starting)        | 0.3 A       |
| Input Current (Short Circuit)   | 0.24-0.36 A |
| Secondary Short Circuit Current | 1.35-1.65 A |
| Constant Wattage Deviation      | 12%         |
| Ballast Factor (Nom)            | 1           |
| Power Factor (Nom)              | 0.90        |
| Open Circuit Voltage            | 260 V       |
| Input Current (Nom)             | 0.3 A A     |
| Input Power (Nom)               | 132 W       |
| Rated Lamp Power                | 100W W      |

| Wiring               |          |
|----------------------|----------|
| Wire Striplength     | 0.5 mm   |
| Wire Length By Color | 12"      |
| Wire Type            | Stranded |

## Core & Coil (71A) MH ~LT~ 175W

|   |     |
|---|-----|
| Remote Wiring Configuration Allowed     | Yes |
| Max Ballast-Lamp Distance Remote Wiring | 25' |
| Recommended Fuse Value                  | 2 A |

### Approval and Application

|                                   |           |
|-----------------------------------|-----------|
| Open Circuit Voltage Test (Volts) | 234-286 V |
| Temperature Marking               | C         |
| UL Recognized                     | Yes       |
| Hipot Test (1 Minute)             | 2000 V    |
| Hipot Test (2 Seconds)            | 2500 V    |
| UL Insulation Class               | H(180°C)  |
| UL Temperature Code               | 1029C     |

### Product Data

|                                 |                              |
|---------------------------------|------------------------------|
| Order product name              | CORE & COIL HID 71A5340500DT |
| EAN/UPC - Product               | 781087094099                 |
| Order code                      | 913700532809                 |
| Numerator - Quantity Per Pack   | 1                            |
| Numerator - Packs per outer box | 6                            |
| Material Nr. (12NC)             | 913700532809                 |
| Net Weight (Piece)              | 2.627 kg                     |

### Dimensional drawing

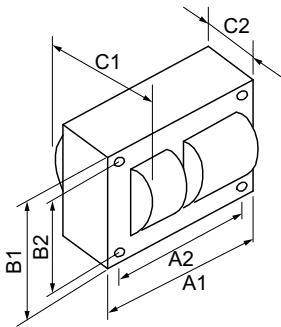

MH BAL 100W M90/140 480V/120T C&C

| Product                      | C1     | C2     | A1     | A2     | B1     | B2     |
|------------------------------|--------|--------|--------|--------|--------|--------|
| CORE & COIL HID 71A5340500DT | 2.9 in | 1.7 in | 3.9 in | 3.5 in | 2.8 in | 2.4 in |

