

Core & Coil (71A) MH 175W - 450W

CORE & COIL HID MH BAL 250W M138/M153 QUAD KIT

The basic ballast is the open core and coil which is most often used as a component within a lighting luminaire. The core and coil also forms the nucleus of Philips Advance's five other ballast configurations.

Product data

| General Information | |
|------------------------------------|------------------------|
| ANSI Code | M138-M153 |
| Lamp Type | 250W MH |
| Number of Lamps | 1 piece/unit |
| Circuit Type | SUPER-CWA |
| Ballast Type | Magnetic HID |
| Base Model | 71A5792A |
| Core Size | 4 1/4 x 4 3/4 (2 coil) |
| Suitable For Outdoor Use | Yes |
| Ignitor Catalog Number | LI533-H4 |
| Ignitor Temperature Rating | 105°C |
| Capacitor Value | 17 MFD |
| Capacitor Catalog Number | 7C170P40 |
| Capacitor Requirements | 330V |
| Capacitor Temperature Rating | 105°C |
| Capacitor Diameter/Oval Dimensions | 1.75 in |
| Capacitor Height | 3.75 in |
| Automatic Restart | No |

| Operating and Electrical | |
|---------------------------------|---------------------------------------|
| Input Voltage | 120/208/240/277 V |
| Input Frequency | 60 Hz |
| Power (Rated) (Nom) | 250 W |
| Inp. Current (Open Circuit) | 1.4/0.8/0.7/0.65 A |
| Input Current (Starting) | 1.9/1.1/0.96/0.85 A |
| Input Current (Short Circuit) | 1.58-2.4/0.9-1.35/0.8-1.2/0.68-1.05 A |
| Secondary Short Circuit Current | 2.38-2.9 A |
| Constant Wattage Deviation | 10% |
| Ballast Factor (Nom) | 1 |
| Power Factor (Nom) | 0.90 |
| Nominal Open Circuit Voltage | 275 V |
| Input Current (Operating) (Nom) | 2.5/1.45/1.25/1.1 A A |
| Input Power (Nom) | 291 W |
| Rated Lamp Watts | 250W W |

| Wiring | |
|----------------------|--------|
| Wire Striplength | 0.5 mm |
| Wire Length By Color | 12" |

Core & Coil (71A) MH 175W - 450W

| | |
|---|-----------|
| Wire Type | Stranded |
| Remote Wiring Configuration Allowed | Yes |
| Max Ballast-Lamp Distance Remote Wiring | 5' |
| Recommended Fuse Value | 8/5/5/3 A |

Approval and Application

| | |
|-----------------------------------|------------------------------------|
| Open Circuit Voltage Test (Volts) | 250-300 V |
| Approbation Marks | ULR CSA certificate RoHS Compliant |
| Temperature Marking | A/A/A/A |
| UL Recognized | Yes |
| Hipot Test (1 Minute) | 1500 V |
| Hipot Test (2 Seconds) | 2500 V |
| UL Insulation Class | H(180°C) |

| | |
|---------------------|-------|
| UL Temperature Code | 1029A |
|---------------------|-------|

Product Data

| | |
|---------------------------------|-----------------------------|
| Order product name | CORE & COIL HID 71A5792001D |
| EAN/UPC - Product | 781087120804 |
| Order code | 71A5792001D |
| Local order code | 112896 |
| Numerator - Quantity Per Pack | 1 |
| Numerator - Packs per outer box | 1 |
| Material Nr. (12NC) | 913710413901 |
| Net Weight (Piece) | 4.673 kg |

Dimensional drawing

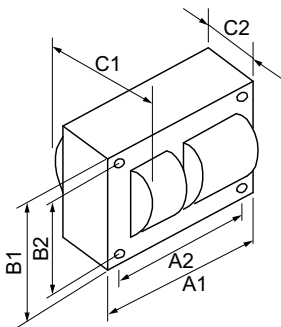

MH BAL 250W M138/M153 QUAD KIT

| Product | C1 | C2 | A1 | A2 | B1 | B2 |
|-----------------------------|--------|--------|--------|--------|--------|--------|
| CORE & COIL HID 71A5792001D | 3.1 in | 1.5 in | 4.8 in | 4.4 in | 4.3 in | 3.9 in |

