

# Core & Coil (71A) MH 175W - 450W

## CORE & COIL HID MH BAL 250W M58 QUAD KIT

The basic ballast is the open core and coil which is most often used as a component within a lighting luminaire. The core and coil also forms the nucleus of Philips Advance's five other ballast configurations.

### Product data

General Information	
ANSI Code	M58
Lamp Type	250W MH
Number of Lamps	1 piece/unit
Circuit Type	CWA
Ballast Type	Magnetic HID
Base Model	71A5771
Core Size	3 X 4 (2 coil)
Suitable For Outdoor Use	Yes
Ignitor Catalog Number	NA
Ignitor Temperature Rating	NA
Capacitor Value	15 MFD
Capacitor Catalog Number	7C150P40R
Capacitor Requirements	400V
Capacitor Temperature Rating	105°C
Capacitor Diameter/Oval Dimensions	1.75 in
Capacitor Height	3.75 in
Automatic Restart	No

Operating and Electrical	
Input Voltage	120/208/240/277 V
Input Frequency	60 Hz
Power (Rated) (Nom)	250 W
Inp. Current (Open Circuit)	2.6/1.5/1.3/1.1 A
Input Current (Starting)	1/0.6/0.5/0.45 A
Input Current (Short Circuit)	1.2-1.8/0.7-1/0.6-0.9/0.5-0.75 A
Secondary Short Circuit Current	2-3 A
Constant Wattage Deviation	8%
Ballast Factor (Nom)	1
Power Factor (Nom)	0.90
Nominal Open Circuit Voltage	300 V
Input Current (Operating) (Nom)	2.6/1.5/1.3/1.1 A A
Input Power (Nom)	294 W
Rated Lamp Watts	250W W

Wiring	
Wire Striplength	0.5 mm
Wire Length By Color	12"
Wire Type	Stranded

## Core & Coil (71A) MH 175W - 450W

Remote Wiring Configuration Allowed	Yes
Max Ballast-Lamp Distance Remote Wiring	Determined by AWG used
Recommended Fuse Value	8/5/5/3 A

### Approval and Application

Open Circuit Voltage Test (Volts)	270-330 V
Approbation Marks	ULR CSA certificate RoHS Compliant
Temperature Marking	C/C/D/D
UL Recognized	Yes
Hipot Test (1 Minute)	2000 V
Hipot Test (2 Seconds)	2500 V
UL Insulation Class	H(180°C)

UL Temperature Code	1029D
---------------------	-------

### Product Data

Order product name	CORE & COIL HID 71A5771001D
EAN/UPC - Product	781087096475
Order code	71A5771001D
Numerator - Quantity Per Pack	1
Numerator - Packs per outer box	1
Material Nr. (12NC)	913700534909
Net Weight (Piece)	4.614 kg

### Dimensional drawing

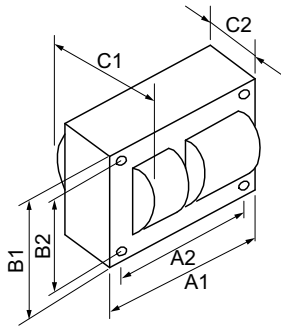

MH BAL 250W M58 QUAD KIT

Product	C1	C2	A1	A2	B1	B2
CORE & COIL HID 71A5771001D	4.2 in	3 in	3.9 in	3.5 in	2.8 in	2.4 in

