

# Core & Coil (71A) HPS ~GT~ 400W

**CORE & COIL HID HPS BAL 750W S111  
120/208/240V C&C**

The basic ballast is the open core and coil which is most often used as a component within a lighting luminaire. The core and coil also forms the nucleus of Philips Advance's five other ballast configurations.

## Product data

General Information		Operating and Electrical	
ANSI Code	S111	Input Voltage	120/208/240 V
Lamp Type	750W HPS	Input Frequency	60 Hz
Number of Lamps	1 piece/unit	Power (Rated) (Nom)	750 W
Circuit Type	CWA	Inp. Current (Open Circuit)	3/1.75/1.6 A
Ballast Type	Magnetic HID	Input Current (Starting)	6.3/3.7/3.2 A
Base Model	71A86E5	Input Current (Short Circuit)	4.4-6.5/2.5-3.85/2.2-3.4 A
Core Size	4 1/4 x 6	Secondary Short Circuit Current	9.2-11.25 A
Suitable For Outdoor Use	Yes	Constant Wattage Deviation	Within Trapezoid
Ignitor Catalog Number	LI561-H5	Ballast Factor (Nom)	1
Ignitor Temperature Rating	105°C	Power Factor (Nom)	0.90
Capacitor Value	75 MFD	Nominal Open Circuit Voltage	220 V
Capacitor Catalog Number	7C750S28RA	Input Current (Operating) (Nom)	6.75/4/3.5 A A
Capacitor Requirements	280V	Input Power (Nom)	840 W
Capacitor Temperature Rating	105°C	Rated Lamp Watts	750W W
Capacitor Diameter/Oval Dimensions	2.05 in		
Capacitor Height	5 in		
Automatic Restart	No		
		Wiring	
		Wire Striplength	0.5 mm
		Wire Length By Color	12"

## Core & Coil (71A) HPS ~GT~ 400W

Wire Type	Stranded
Remote Wiring Configuration Allowed	Yes
Max Ballast-Lamp Distance Remote Wiring	5'
Recommended Fuse Value	20/10/10 A

### Approval and Application

Open Circuit Voltage Test (Volts)	200-245 V
Approbation Marks	ULR CSA certificate RoHS Compliant
Temperature Marking	D/E/E
UL Recognized	Yes
Hipot Test (1 Minute)	2000 V
Hipot Test (2 Seconds)	2500 V
UL Insulation Class	H(180°C)

UL Temperature Code	1029E
---------------------	-------

### Product Data

Order product name	CORE & COIL HID 71A86E5500D
EAN/UPC - Product	781087865552
Order code	71A86E5500D
Numerator - Quantity Per Pack	1
Numerator - Packs per outer box	2
Material Nr. (12NC)	913700539909
Net Weight (Piece)	10.429 kg

### Dimensional drawing

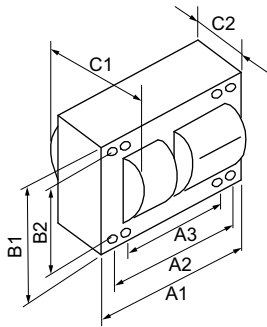

HPS BAL 750W S111 120/208/240V C&C

Product	C1	C2	A1	A2	A3	B1	B2
CORE & COIL HID 71A86E5500D	5.10 in	3.15 in	6 in	5.4 in	4.4 in	4.3 in	3.9 in

