

LABELING PLATE SNAP-ON OR SELF-ADHESIVE FOR LABEL HOLDER, LABEL SIZE 12.5 X 27MM, LABEL SILVER, LETTERING BLACK, WITH INSCRIPTION: RESET



Figure similar

| | |
|-----------------------|----------------------------------|
| product brand name | SIRIUS ACT |
| Product designation | Commanding and signaling devices |
| Design of the product | Label |

General technical data:

| | |
|---|-------------------------|
| Protection class IP | IP66, IP67, IP69(IP69K) |
| Shock resistance | Category 1, Class B |
| <ul style="list-style-type: none"> for railway applications acc. to DIN EN 61373 | |
| Vibration resistance | Category 1, Class B |
| <ul style="list-style-type: none"> for railway applications acc. to DIN EN 61373 | |

Installation/ mounting/ dimensions:

| | |
|--------|---------|
| Height | 12.5 mm |
| Width | 27 mm |

Accessories:

| | |
|---|---------------------------|
| Material of accessory | Plastic |
| Mounting type of label | snap on / stick |
| Marking of the name plate for command devices | Reset |
| Shape of the name plate for command devices | rectangular |
| Color of the label | silver/black (plate/text) |

Certificates/approvals

| | | | |
|--------------------------|--------------------------------|---------------------------|-------------------|
| General Product Approval | For use in hazardous locations | Declaration of Conformity | Test Certificates |
|--------------------------|--------------------------------|---------------------------|-------------------|



[Herstellereklärung](#)



[Werksbescheinigung](#)

[gen](#)

| | |
|-------------------|-------|
| Test Certificates | other |
|-------------------|-------|

[spezielle Prüfbescheinigungen](#)

[Bestätigungen](#)

Further information

Information- and Downloadcenter (Catalogs, Brochures,...)

<http://www.siemens.com/industrial-controls/catalogs>

Industry Mall (Online ordering system)

<https://mall.industry.siemens.com/mall/en/en/Catalog/product?mlfb=3SU19000AC810DU0>

Cax online generator

<http://support.automation.siemens.com/WW/CAXorder/default.aspx?lang=en&mlfb=3SU19000AC810DU0>

Service&Support (Manuals, Certificates, Characteristics, FAQs,...)

<https://support.industry.siemens.com/cs/ww/en/ps/3SU19000AC810DU0>

Image database (product images, 2D dimension drawings, 3D models, device circuit diagrams, EPLAN macros, ...)

http://www.automation.siemens.com/bilddb/cax_de.aspx?mlfb=3SU19000AC810DU0&lang=en

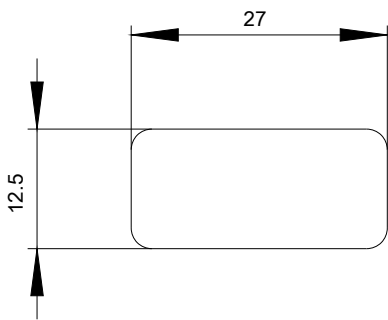

last modified:

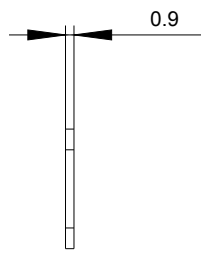

31.03.2016