

SIEMENS

Max - Flex™ Operators
Operadores Max-Flex™
Opérateurs Max-Flex™

Item: FHONBO	FHONC048	FHONC096
FHONO_ _ _ _	FHONC060	FHONC120
FHOHN	FHONC072	FHONC144
FHOHN4	FHONC084	

For Use With Breaker Types:
MD6, MXD6, HMD6, HMXD6, ND6, NXD6, HNXD6, HND6, CMD6, CND6, PD6, PXD6, HPD6, HPXD6, RD6, RXD6, HRD6, HRXD6, CPD6, CRD6, SMD6, SND6, SPD6, SHMD6, SHND6, SHPD6, SCMD6, SCND6, MFC, NFC, NFF

Motor Circuit Protection and Molded Case Switch Types: MXD6,
Para Usar Con Interruptor Tipos:
MD6, MXD6, HMD6, HMXD6, ND6, NXD6, HNXD6, HND6, CMD6, CND6, PD6, PXD6, HPD6, HPXD6, RD6, RXD6, HRD6, HRXD6, CPD6, CRD6, SMD6, SND6, SPD6, SHMD6, SHND6, SHPD6, SCMD6, SCND6, MFC, NFC, NFF

Circuito de Protección para Motor e Interruptor de Caja Moldeado Tipos : MXD6

Installation Instructions / Instructivo de Instalación

	 Danger	 Peligro	 Danger
	Hazardous Voltage. Will cause death or serious injury.	Tensión peligrosa. Puede causar la muerte o lesiones graves.	Tension dangereuse. Danger de mort ou risque de blessures graves.
	Turn off and lock out all power supplying this device before working on this device. Replace all covers before power supplying this device is turned on.	Desenergice totalmente antes de instalar o darle servicio. Reemplace todas las barreras y cubiertas antes de energizar el interruptor.	Couper l'alimentation de l'appareil et barrer avant de travailler. Remplacez tous les couverts avant que l'alprovisionnement de pouvoir soit alimenté.

Use only with Siemens certified Components.
Utilizar únicamente con componentes certificados de Siemens.
A utiliser uniquement avec les composants certifiés Siemens.

FHON048	Suitable For Type 1,2,3,3R,12,13 enclosures [Apto par tipo 1,2,3,3R,12,13 caja]
FHOHN	Suitable For Type 1,2,3,3R,4,4X,12,13 enclosures [Apto par tipo 1,2,3,3R,4,4X,12,13 caja]
FHOHN4	Suitable For Type 1,2,3,3R,4,4X,12,13 enclosures [Apto par tipo 1,2,3,3R,4,4X,12,13 caja]

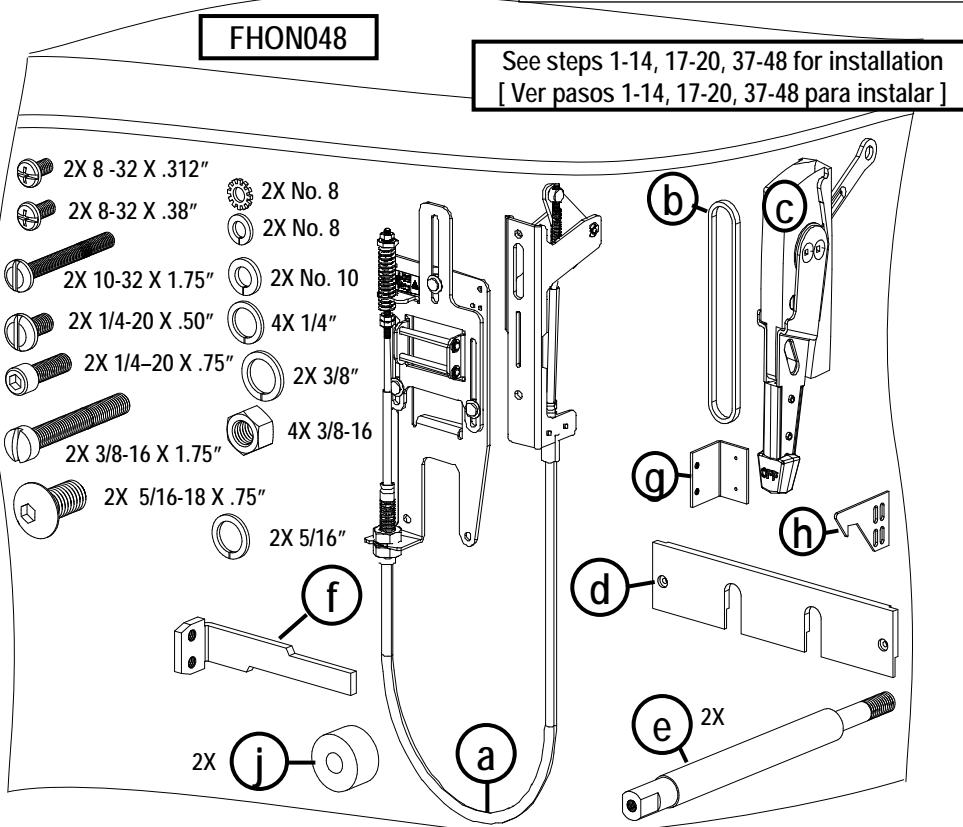
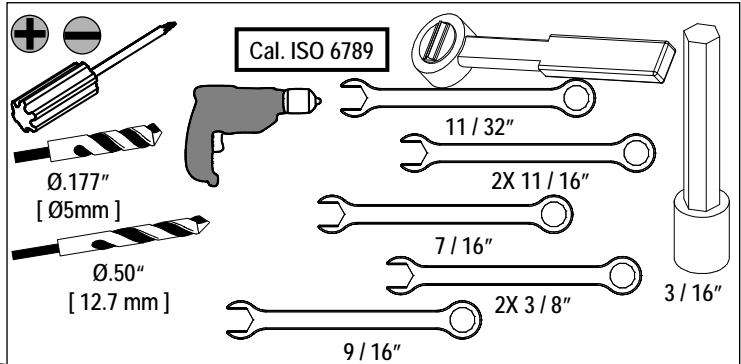

- 2X 8 - 32 X .312"
- 2X 8-32 X .38"
- 2X 10-32 X 1.75"
- 2X 1/4-20 X .50"
- 2X 1/4-20 X .75"
- 2X 3/8-16 X 1.75"
- 2X 5/16-18 X .75"
- 2X No. 8
- 2X No. 8
- 2X No. 10
- 4X 1/4"
- 2X 3/8"
- 4X 3/8-16
- 2X 5/16"

See steps 21-48 for installation
[Ver pasos 21-48 para instalar]

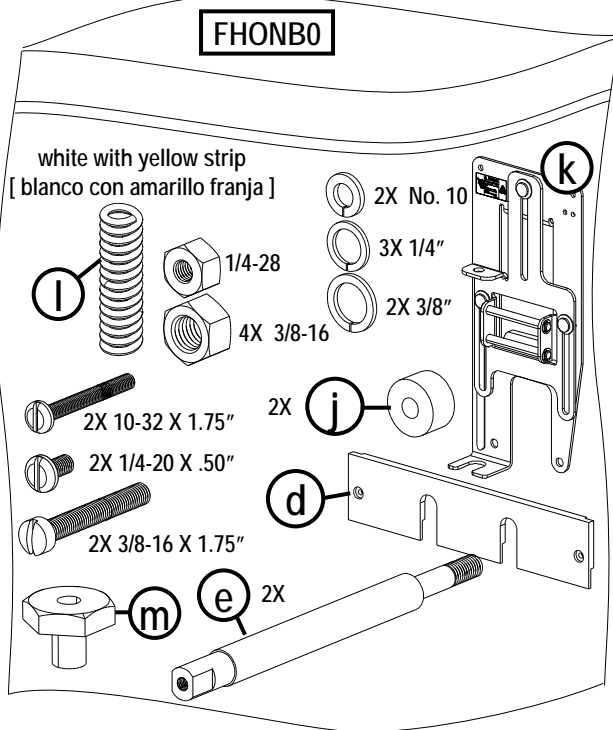

See steps 17-20 for installation
[Ver pasos 17-20 para instalar]

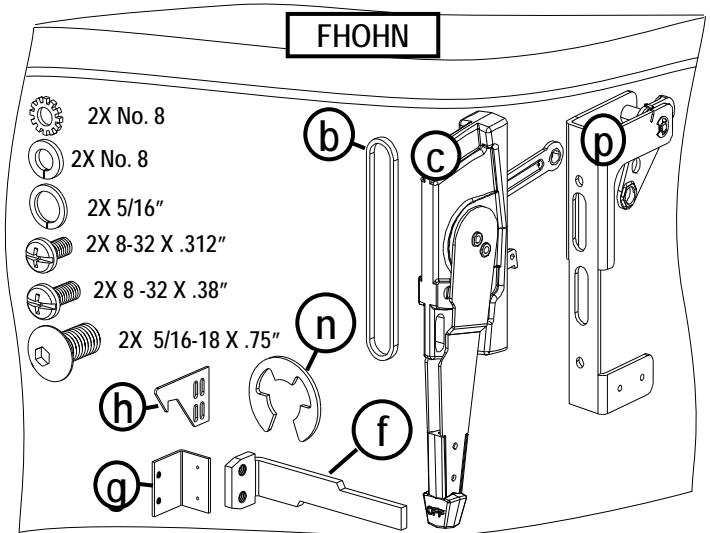

See steps 17-20 for installation
[Ver pasos 17-20 para instalar]

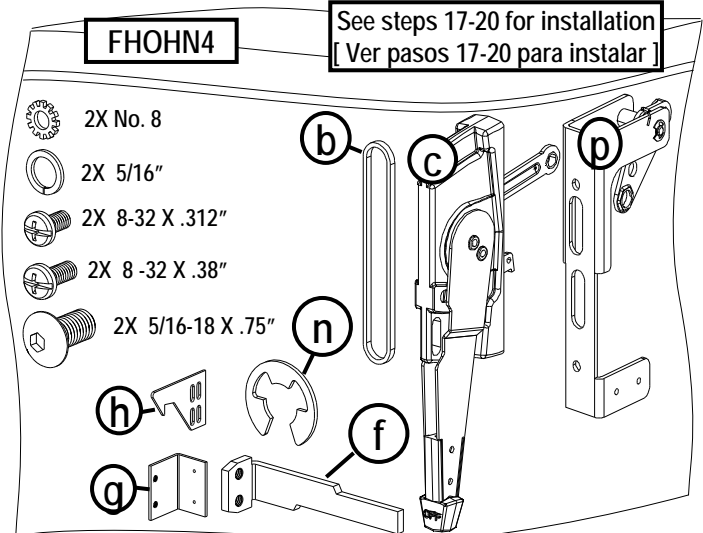

See steps 15, 16, 32-48 for installation
[Ver pasos 15, 16, 32-48 para instalar]

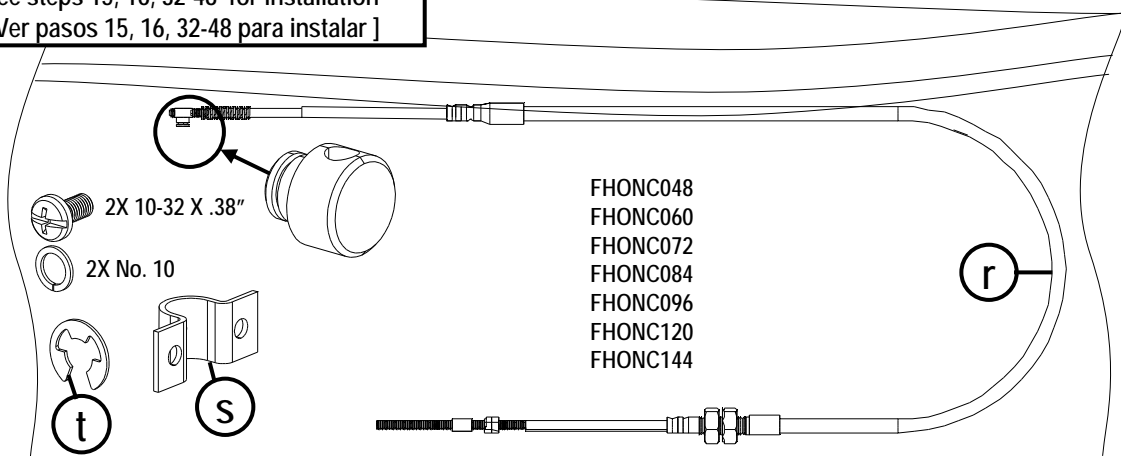



Danger

Hazardous Voltage.
Will cause death or serious injury.

Turn off and lock out all power supplying this device before working on this device.
Replace all covers before power supplying this device is turned on.



Peligro

Tensión peligrosa.
Puede causar la muerte o lesiones graves.
Desenergice totalmente antes de instalar o darle servicio.
Reemplace todas las barreras y cubiertas antes de energizar el interruptor.

Danger

Tension dangereuse.
Danger de mort ou risque de blessures graves.
Couper l'alimentation de l'appareil et barrer avant de travailler.
Remplacez tous les couverts avant que l'alimentation de pouvoir soit alimenté.

Dimensions for Welded or Screw mounting the cover catch.
[Dimensiones para soldar o atornillar el seguro de la puerta.]

1

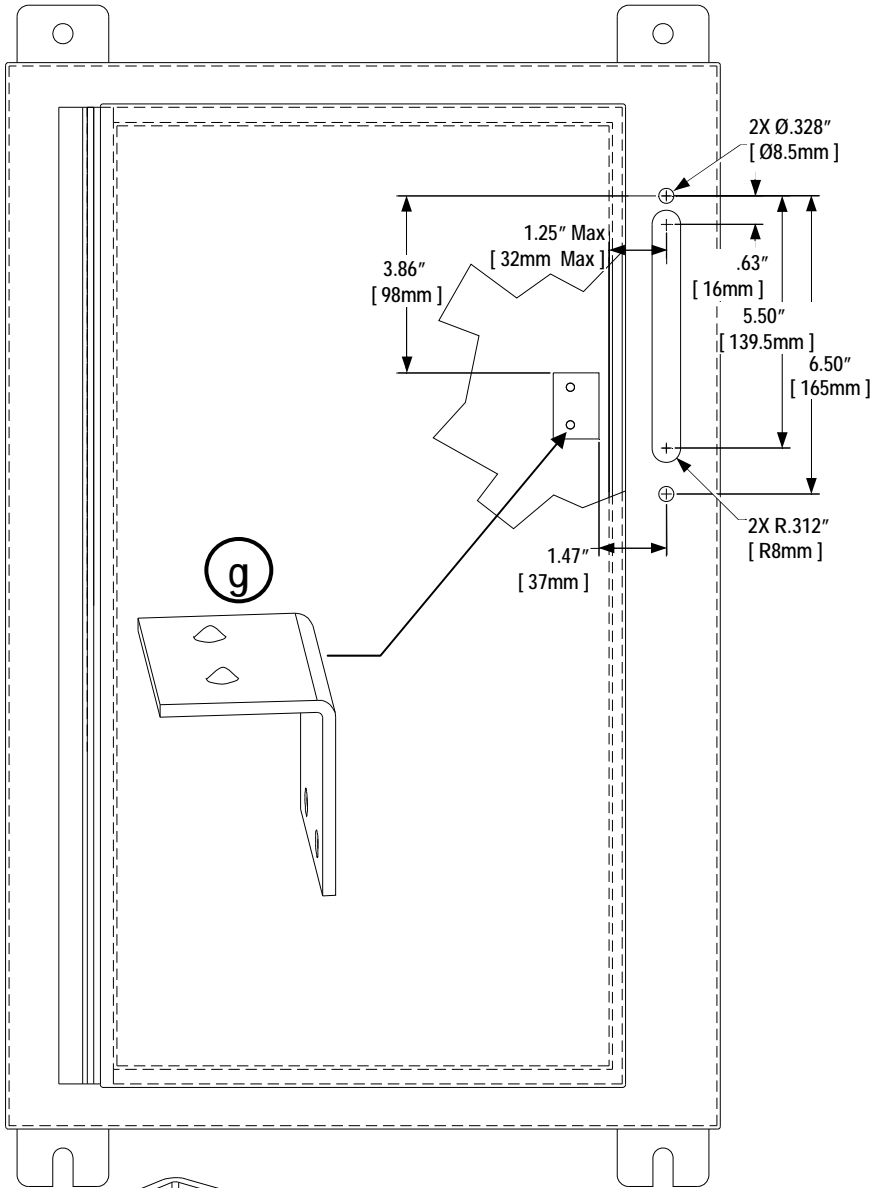

Option:
[Opción:]

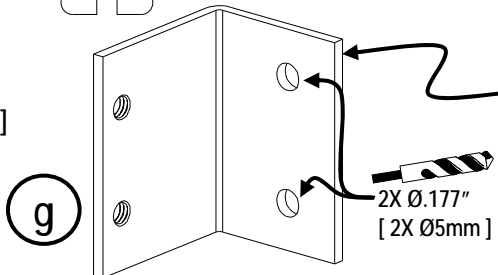

Customer supplied hardware for screw mounting option. Hardware must maintain environmental integrity (NEMA rating) of the enclosure.
[Todos los materiales deben Mantener la integridad ambiental de la caja.]

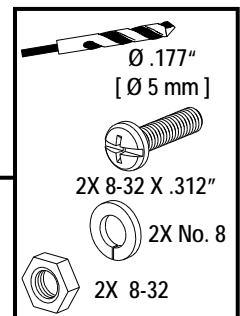

An operator with a FHOHN handle can be used with DKR2, DKR3, DKL2 and DKL3 door latch mechanism.
[El accionador con un mango de FHOH puede ser usado con los equipos de compuerta DKR2, DKR3, DKL2 y DKL3.]

For Use With Breaker Types:

MD6,MXD6,,HMD6,HMXD6,ND6,NXD6,HNXD6,HND6,CMD6,CND6,PD6,PXD6,HPD6,,HPXD6,RD6,RXD6,HRD6,HRXD6,CPD6,CRD6,SMD6,SND6,SPD6,
SHMD6, SHND6, SHPD6,SCMD6,SCND6,MFC.NFC,NFF

Motor Circuit Protection and Molded Case Switch Types: MXD6,

Para Usar Con Interruptor Tipos:

MD6,MXD6,,HMD6,HMXD6,ND6,NXD6,HNXD6,HND6,CMD6,CND6,PD6,PXD6,HPD6,,HPXD6,RD6,RXD6,HRD6,HRXD6,CPD6,CRD6,SMD6,SND6,SPD6,
SHMD6,SHND6,SHPD6,SCMD6,SCND6,MFC.NFC,NFF

Circuito de Protección para Motor e Interruptor de Caja Moldeado Tipos : MXD6

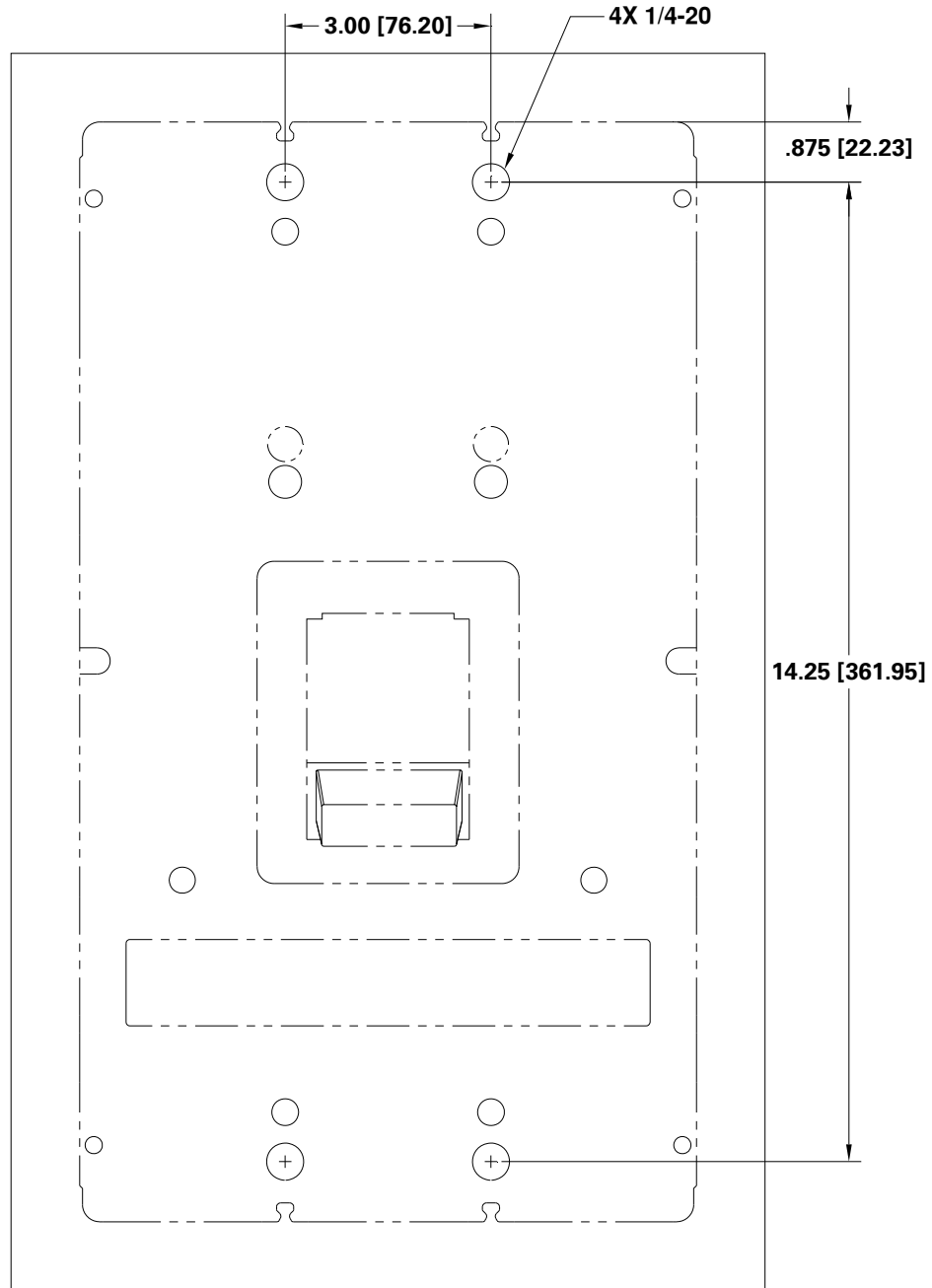

	⚠ Danger	⚠ Peligro	⚠ Danger
	Hazardous Voltage. Will cause death or serious injury. Turn off and lock out all power supplying this device before working on this device. Replace all covers before power supplying this device is turned on.	Tensión peligrosa. Puede causar la muerte o lesiones graves. Desenergice totalmente antes de instalar o darle servicio. Reemplace todas las barreras y cubiertas antes de energizar el interruptor.	Tension dangereuse. Danger de mort ou risque de blessures graves. Couper l'alimentation de l'appareil et barrer avant de travailler. Remplacez tous les couverts avant que l'approvisionnement de pouvoir soit alimenté.

2

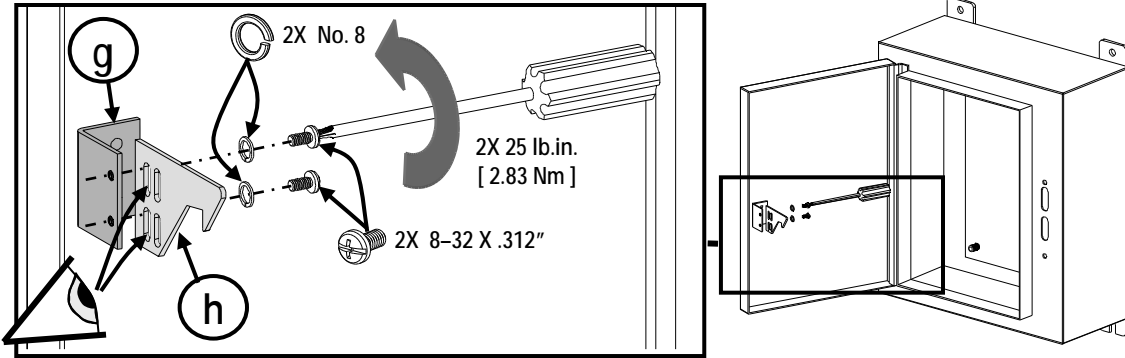

	⚠ WARNING	⚠ ADVERTENCIA	⚠ AVERTISSEMENT
	Hazardous Voltage. Can cause death or serious injury and Equipment Damage. Proper electrical clearances must be maintained	Tensión Peligrosa. Puede causar la muerte o lesiones graves y daños al equipo. Las separaciones eléctricas adecuadas deben ser mantenidas.	Tension dangereuse. Peut provoquer des blessures graves ou mortelles ou causer des dommages à l'équipement. Les dégagements électriques appropriés doivent être maintenus.

Minimum bending radius.
[Radios mínimos de curvatura.]

3

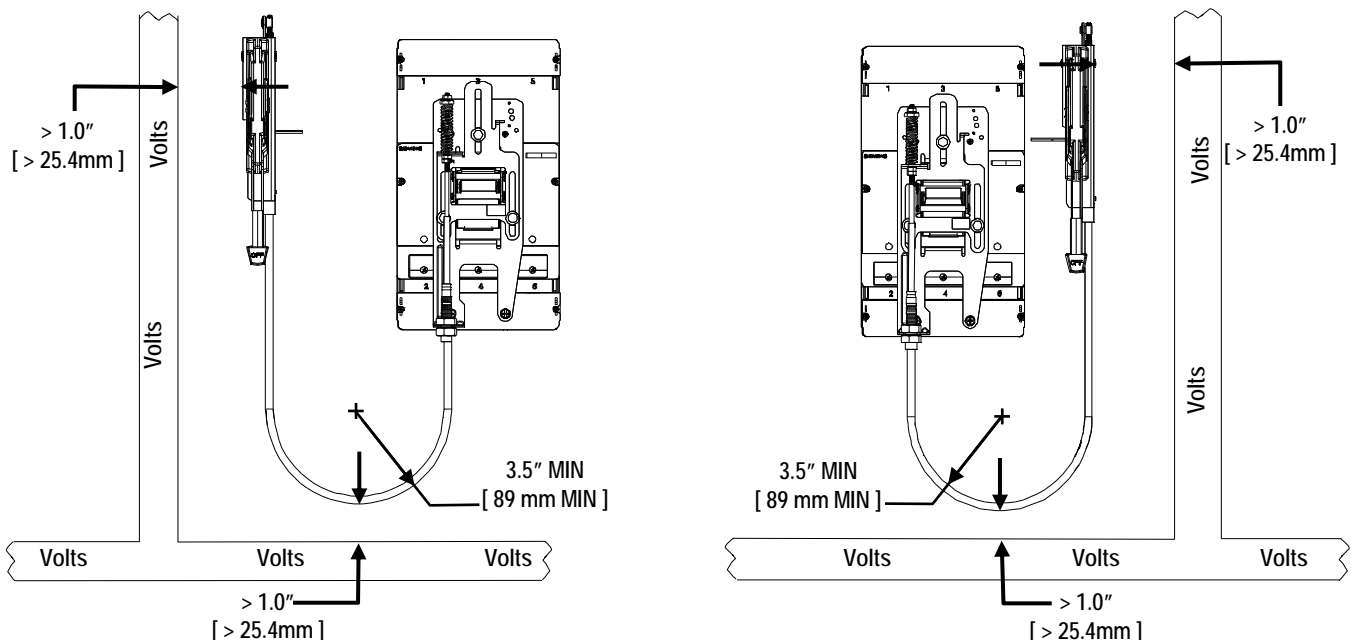

FHON048

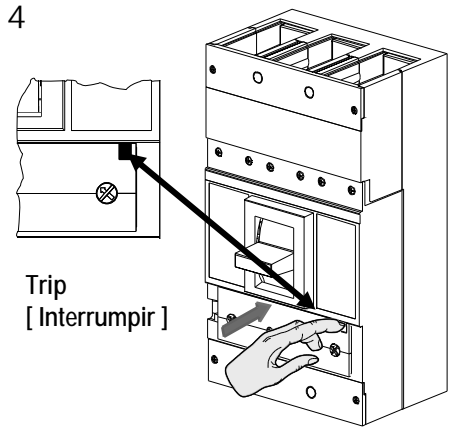

**ONLY
[SOLAMENTE]**

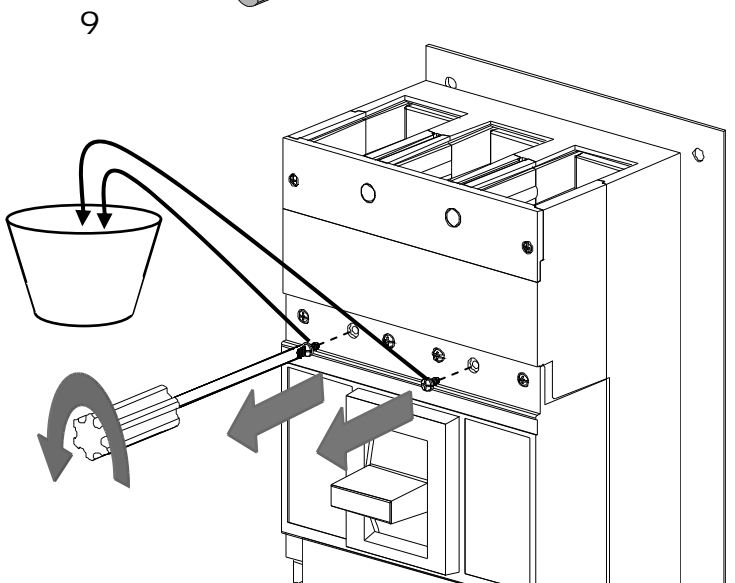
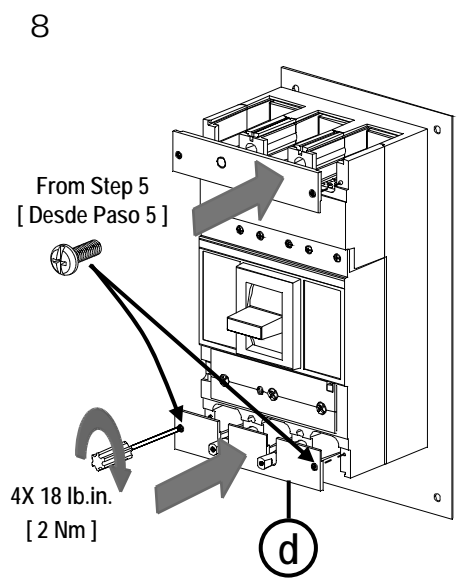
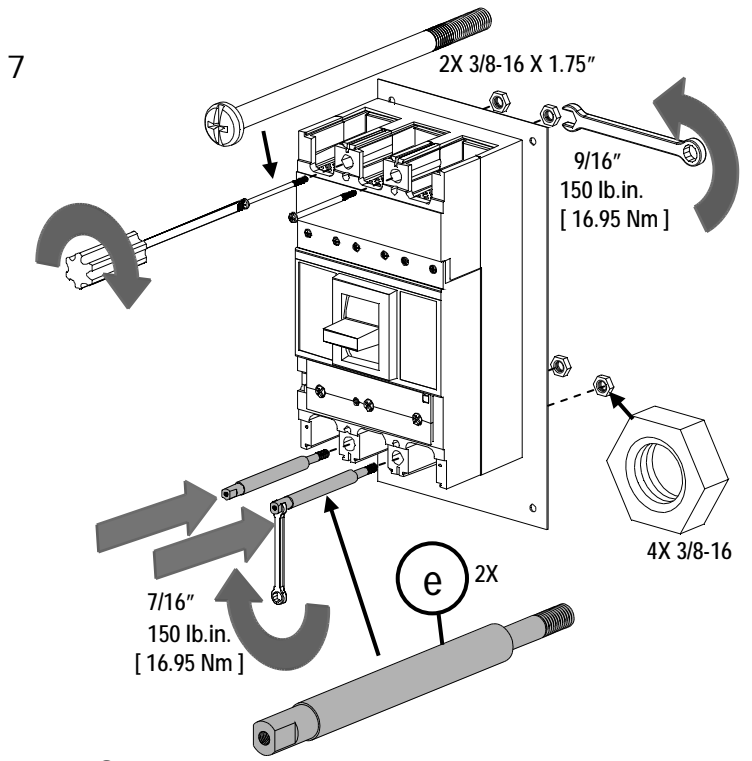
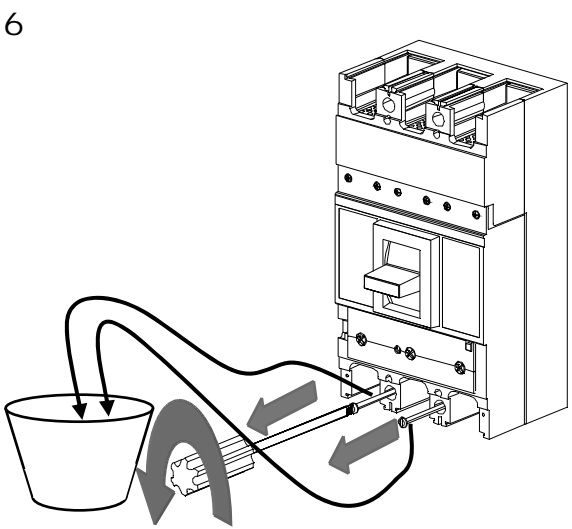
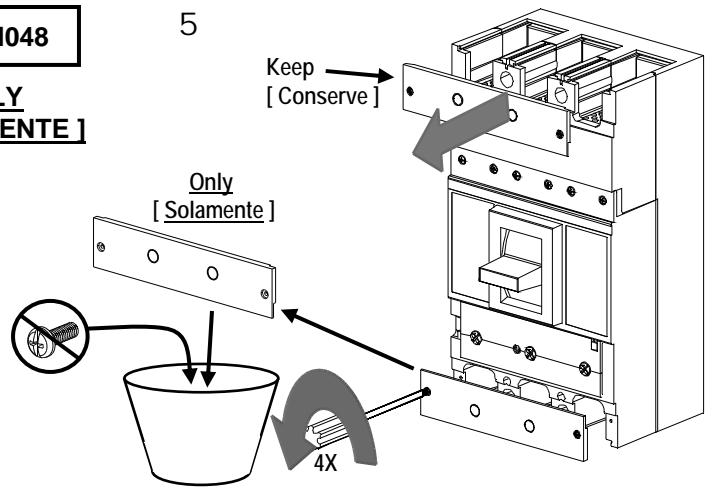



⚠ Danger

Hazardous Voltage.
Will cause death or serious injury.

Turn off and lock out all power supplying this device before working on this device.
Replace all covers before power supplying this device is turned on.

⚠ Peligro

Tensión peligrosa.
Puede causar la muerte o lesiones graves.

Desenergice totalmente antes de instalar o darle servicio.
Reemplace todas las barreras y cubiertas antes de energizar el interruptor.

⚠ Danger

Tension dangereuse.
Danger de mort ou risque de blessures graves.

Couper l'alimentation de l'appareil et barrer avant de travailler.
Remplacez tous les couverts avant que l'alimentation de pouvoir soit alimenté.

10

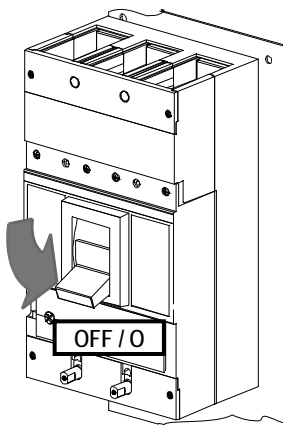

11

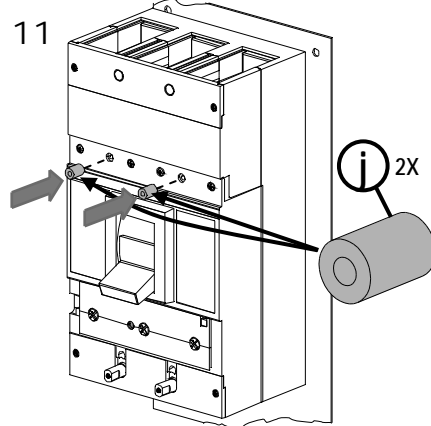

12

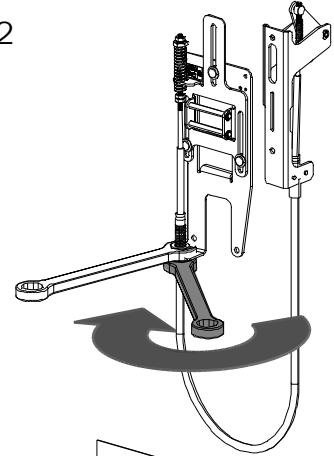

13

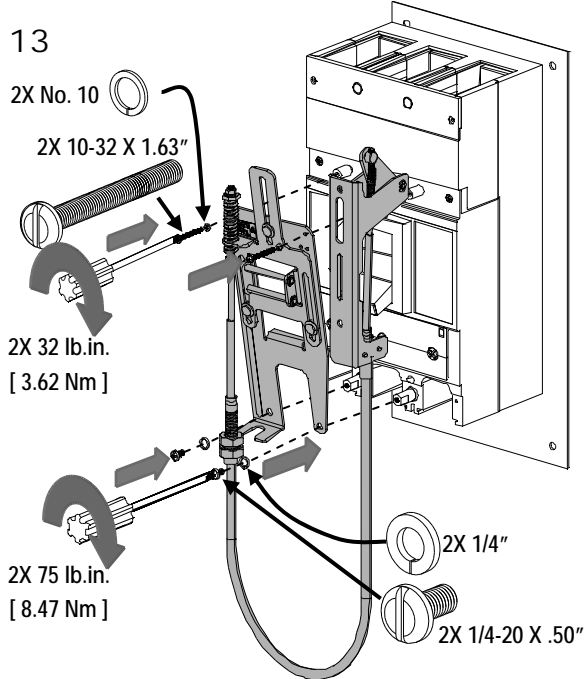

14

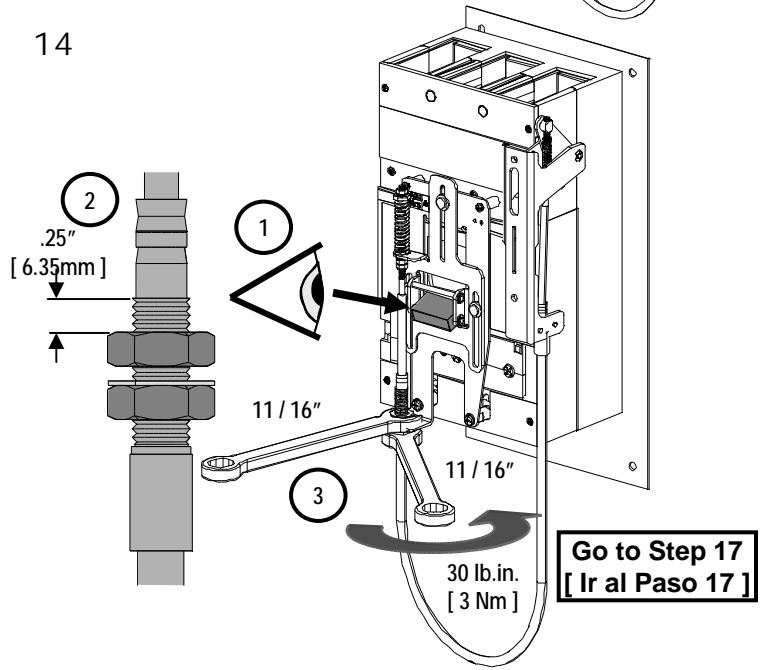

For left hand side mounting and right hand side mounting
[Para montaje de lado izquierdo y lado derecho]

15

FHON ___
FHOHN ___
FHOHN4 ___
FHONC ___

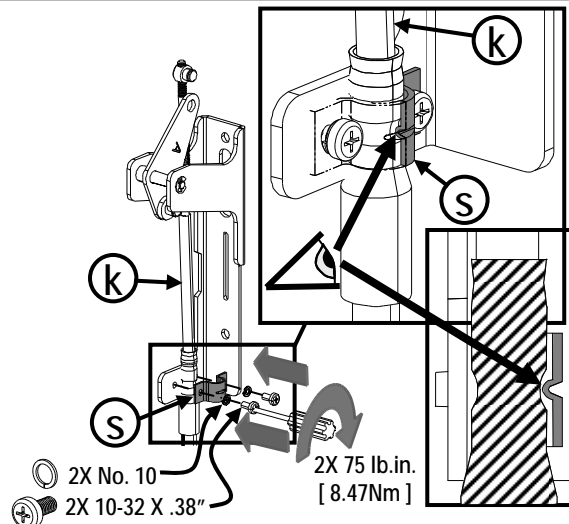

For left hand side mounting and right hand side mounting
 [Para montaje de lado izquierdo y lado derecho]

16

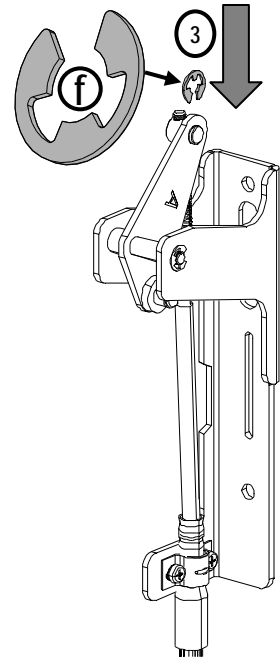
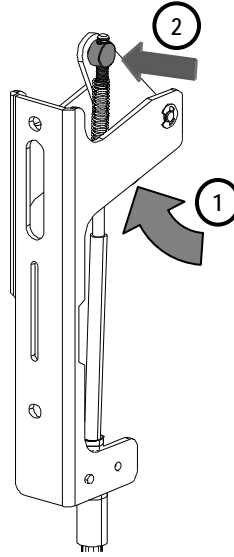
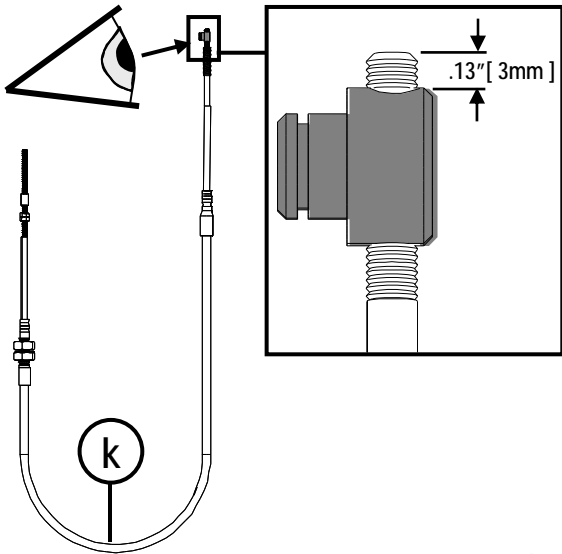

17

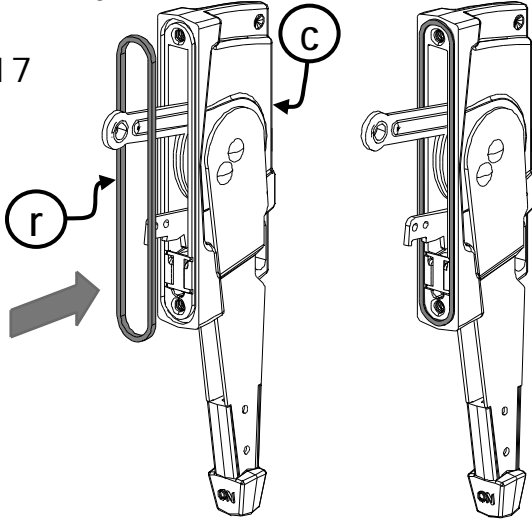

18

Enclosure removed for clarity
 [Caja removida por claridad]

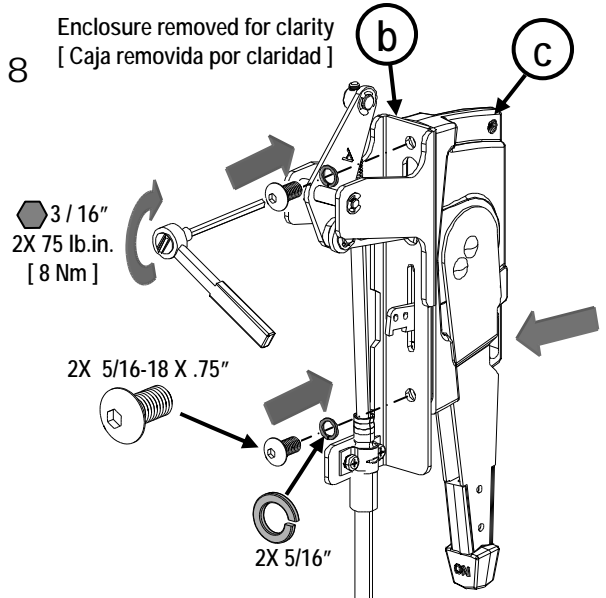

19

Enclosure removed for clarity
 [Caja removida por claridad]

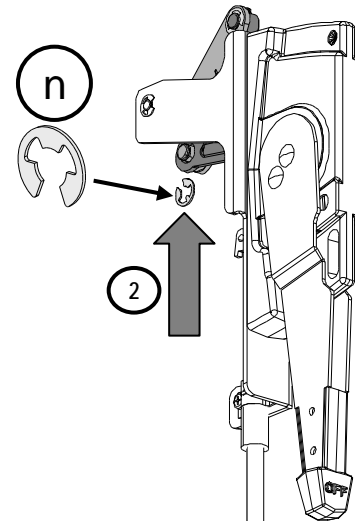
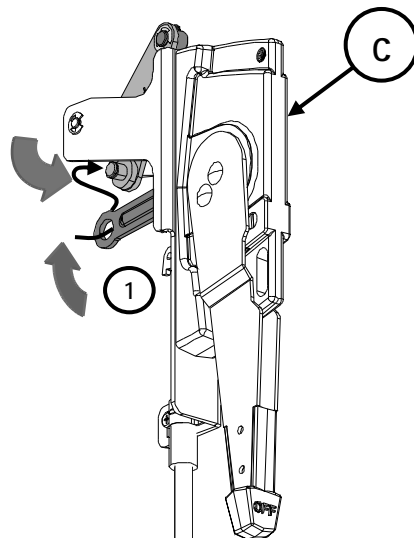



Danger

Hazardous Voltage.
Will cause death or serious injury.
Turn off and lock out all power supplying this device before working on this device.
Replace all covers before power supplying this device is turned on.

Peligro

Tensión peligrosa.
Puede causar la muerte o lesiones graves.
Desenergice totalmente antes de instalar o darle servicio.
Reemplace todas las barreras y cubiertas antes de energizar el interruptor.

Danger

Tension dangereuse.
Danger de mort ou risque de blessures graves.
Couper l'alimentation de l'appareil et barrer avant de travailler.
Remplacez tous les couverts avant que l'approvisionnement de pouvoir soit alimenté.

20

left hand side mounting
[Montaje de lado izquierdo]

Enclosure removed for clarity
[Caja removida por claridad]

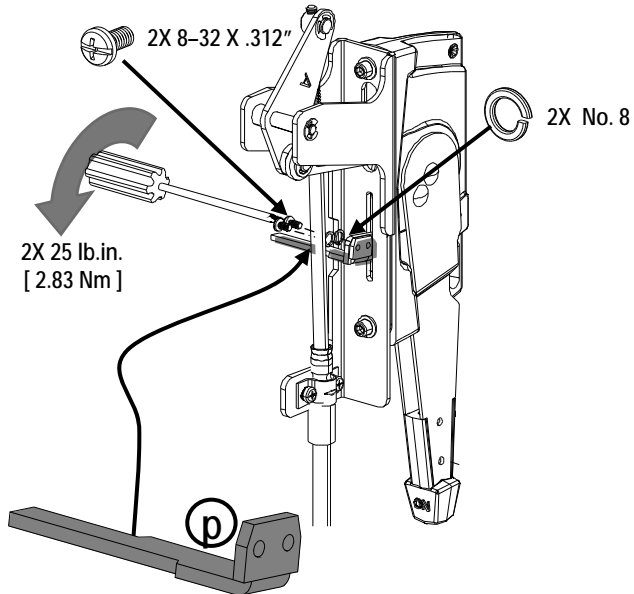

right hand side mounting
[Montaje de lado derecho]

Enclosure removed for clarity
[Caja removida por claridad]

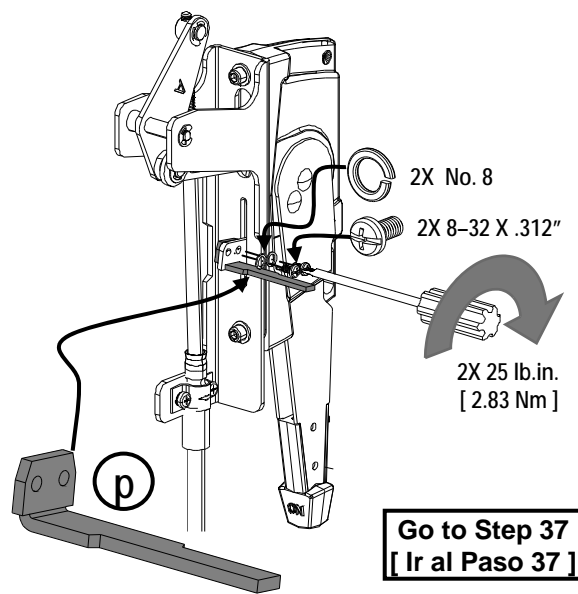

Go to Step 37
[Ir al Paso 37]

FHON
FHONBO

21

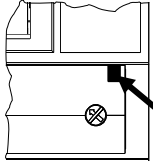

Trip
[Interrumpir]

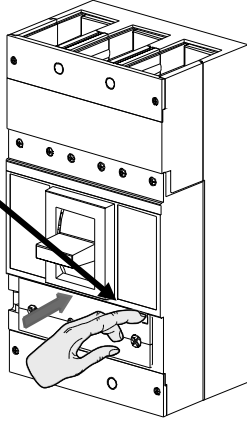

22

Keep
[Conserve]

Only
[Solamente]



4X

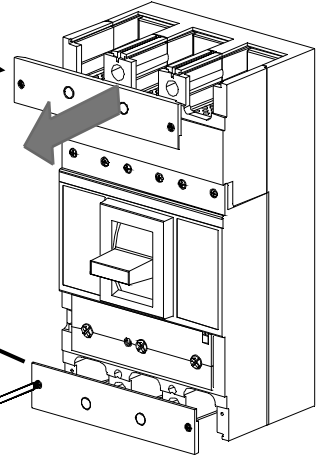

23

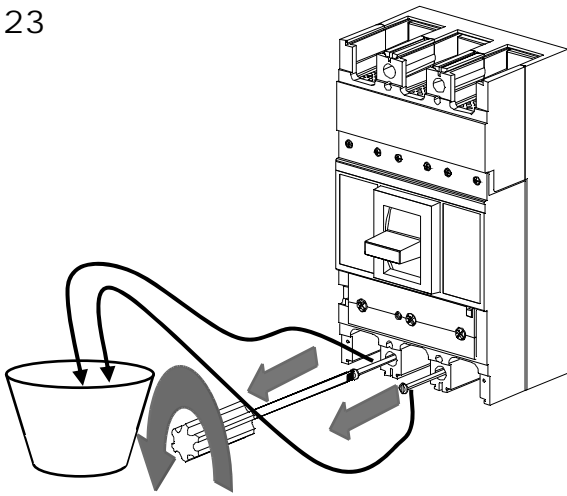

24

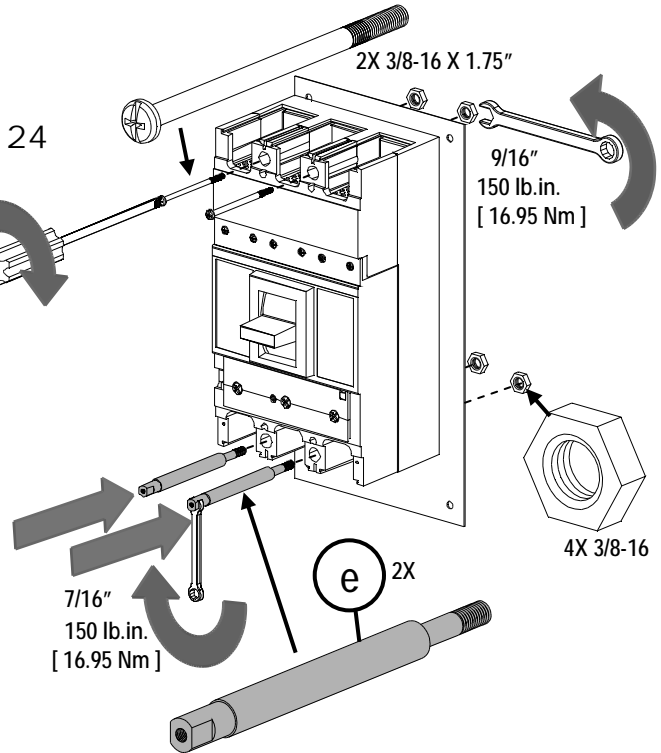

25

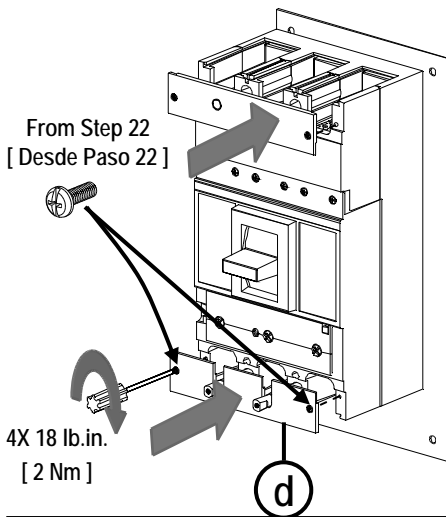

26

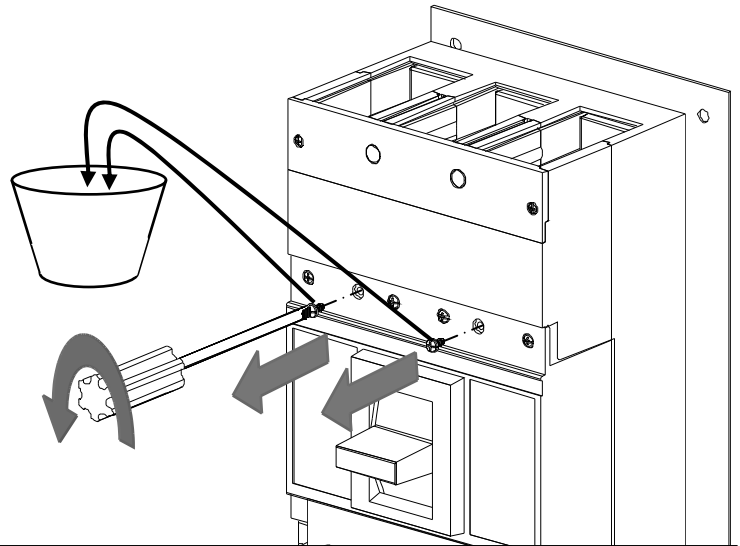



⚠ Danger

Hazardous Voltage.
Will cause death or serious injury.



Turn off and lock out all power supplying this device before working on this device.
Replace all covers before power supplying this device is turned on.

⚠ Peligro

Tensión peligrosa.
Puede causar la muerte o lesiones graves.

Desenergice totalmente antes de instalar o darle servicio.
Reemplace todas las barreras y cubiertas antes de energizar el interruptor.

⚠ Danger

Tension dangereuse.
Danger de mort ou risque de blessures graves.

Couper l'alimentation de l'appareil et barrer avant de travailler.
Remplacez tous les couverts avant que l'alprovisionnement de pouvoir soit alimenté.

27

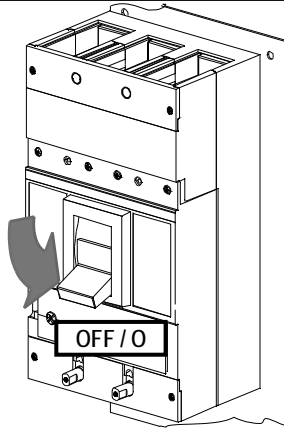

28

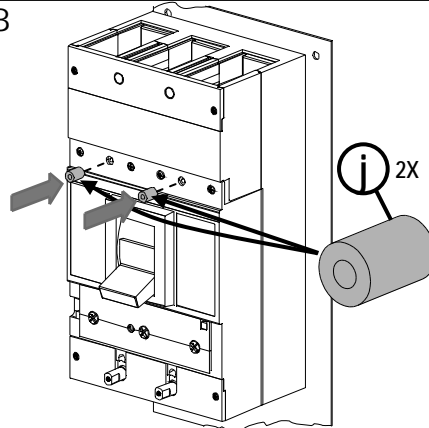

29

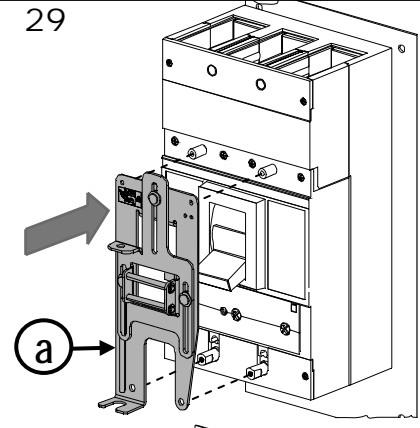

30

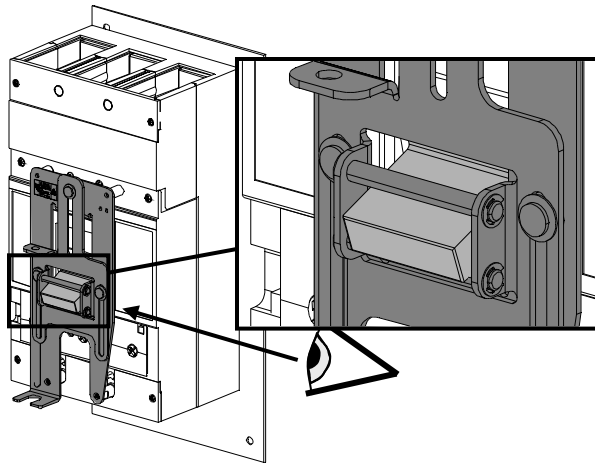

31

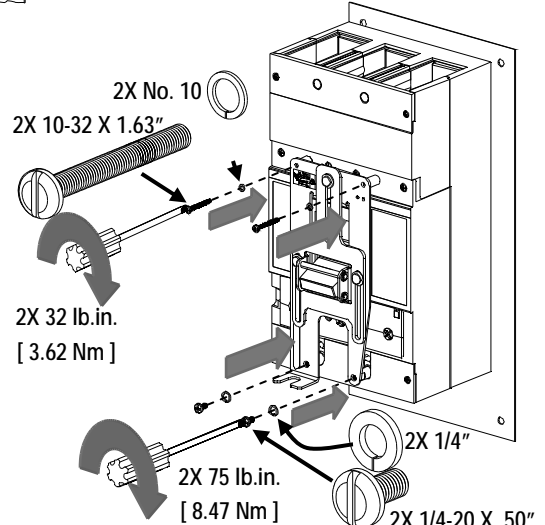

⚠ WARNING

Hazardous Voltage.
Can cause death or serious injury and Equipment Damage.



Proper electrical clearances must be maintained

⚠ ADVERTENCIA

Tensión Peligrosa.
Puede causar la muerte o lesiones graves y daños al equipo.

Las separaciones eléctricas adecuadas deben ser mantenidas.

⚠ AVERTISSEMENT

Tension dangereuse.
Peut provoquer des blessures graves ou mortelles ou causer des dommages à l'équipement.

Les dégagements électriques appropriés doivent être maintenus.

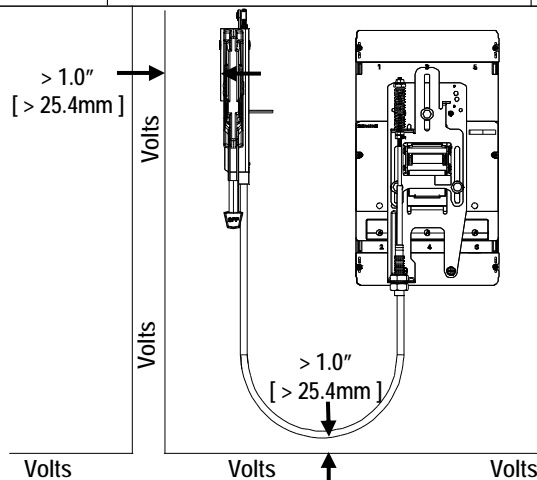

FHON ____
FHONC ____

Ex. FHON048

32

.25"
[6.35mm]

1

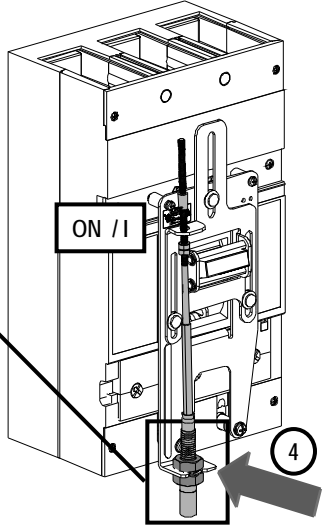
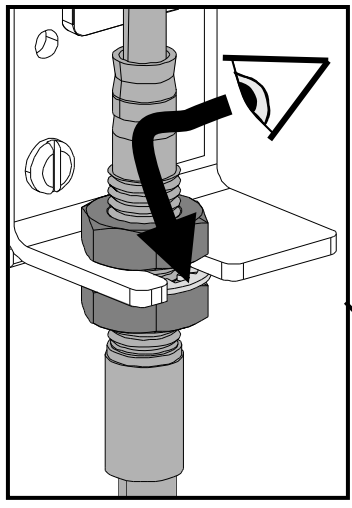
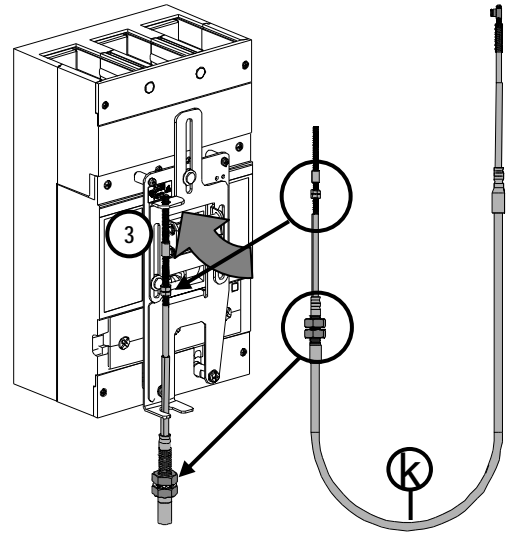
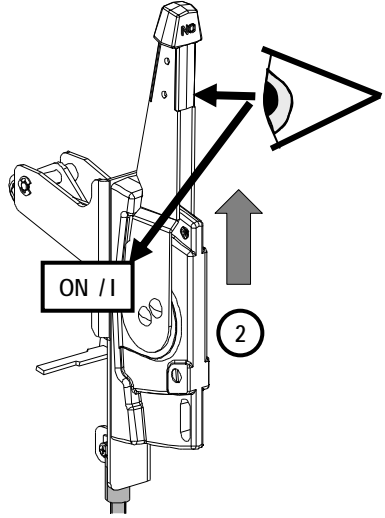

33

35 lb.in.
[4 Nm]

11/16"

11/16"

34

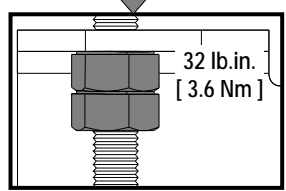
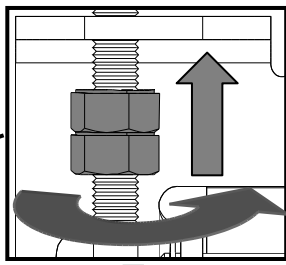
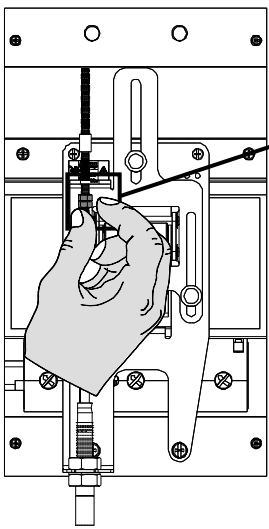

35

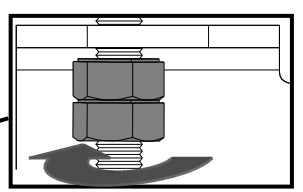
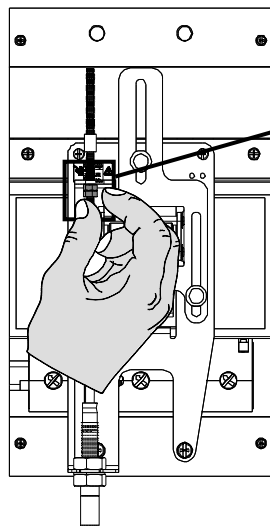

1X



⚠ Danger

Hazardous Voltage.
Will cause death or serious injury.



Turn off and lock out all power supplying this device before working on this device.
Replace all covers before power supplying this device is turned on.

⚠ Peligro

Tensión peligrosa.
Puede causar la muerte o lesiones graves.

Desenergice totalmente antes de instalar o darle servicio.
Reemplace todas las barreras y cubiertas antes de energizar el interruptor.

⚠ Danger

Tension dangereuse.
Danger de mort ou risque de blessures graves.

Couper l'alimentation de l'appareil et barrer avant de travailler.
Remplacez tous les couverts avant que l'alprovisionnement de pouvoir soit alimenté.

36



white with yellow strip
[blanco con amarillo franja]

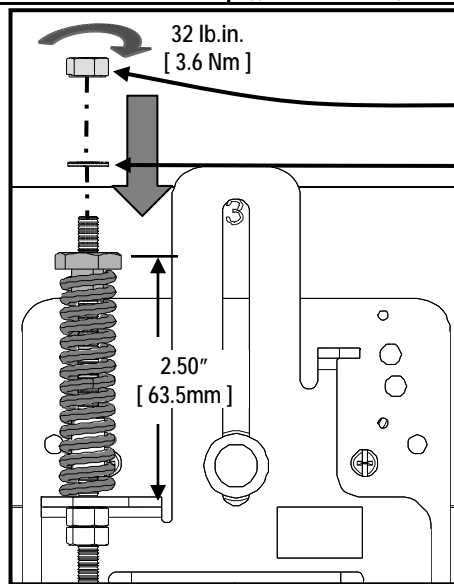
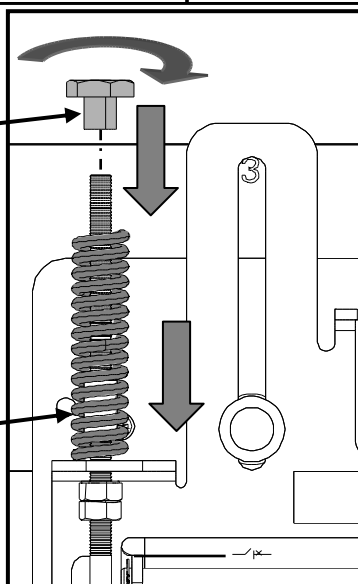

1/4-28



Test: ON / I – OFF / O
[Prueba: ON / I – OFF / O]

37

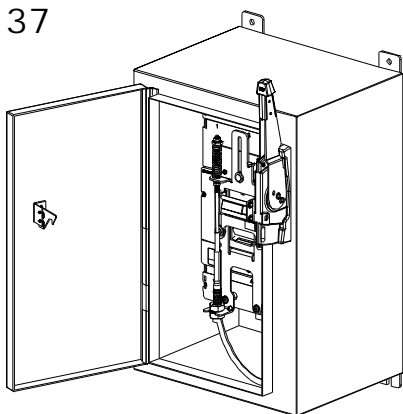

		Result [Resultado]		Go To [Ir Al]
37a	ON / I	OFF / O		Test 37b [Prueba 37b]
		ON / I		Step 38 [Paso 38]
37b	OFF / O	ON / I		Step 40 [Paso 40]
		OFF / O		Step 39 [Paso 39]

38

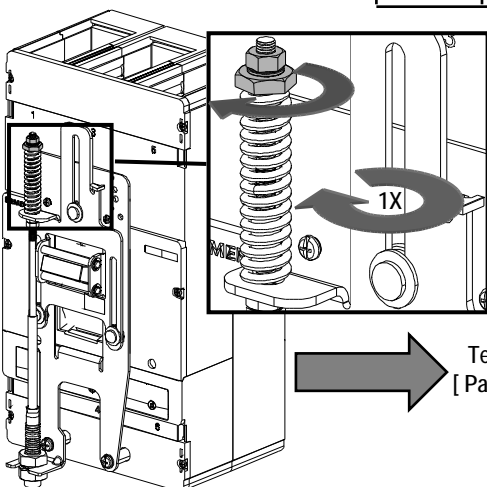

Test 37a
[Paso 37a]

39

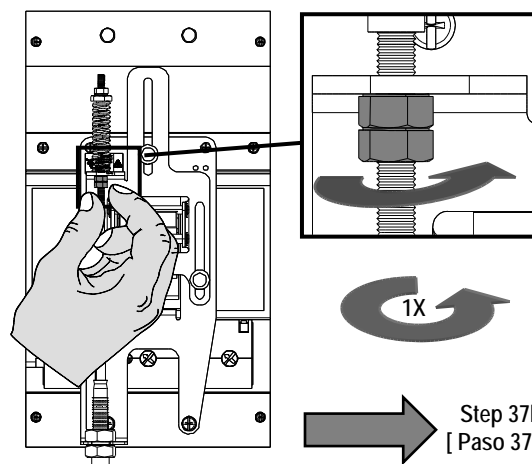

Step 37b
[Paso 37b]

40

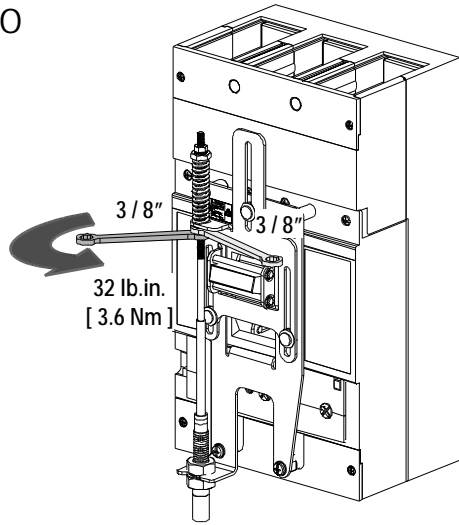

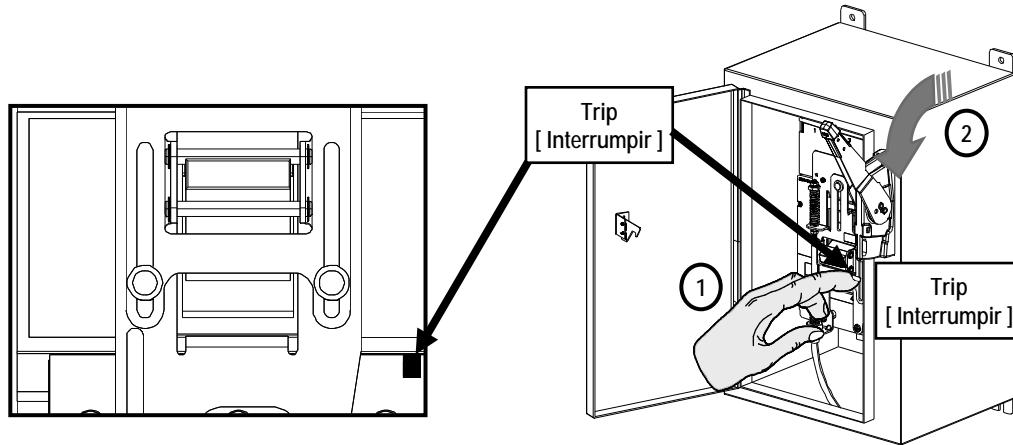

Test: Trip – Reset - ON / I
[Prueba: Interrumpir – Restablecer - ON / I]

41

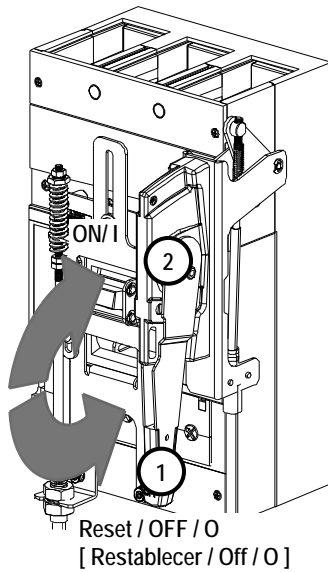

42

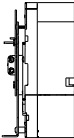

		Result [Resultado]		Go To Step [Ir Al Paso]
				
42	Reset / OFF / O [Restablecer / OFF / O] → ON / I	ON / I	OK	44
		Reset / OFF / O [Restablecer / OFF / O]	OK	43



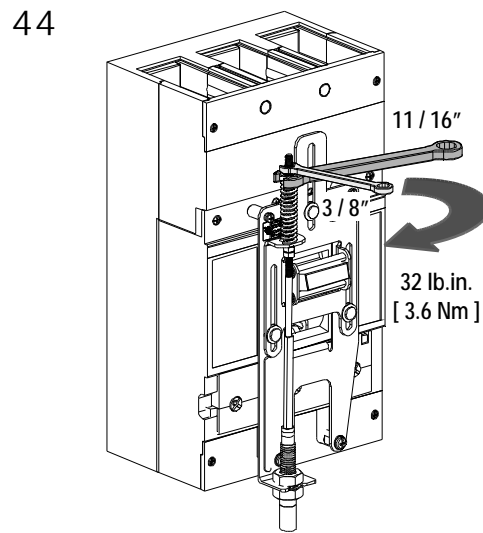
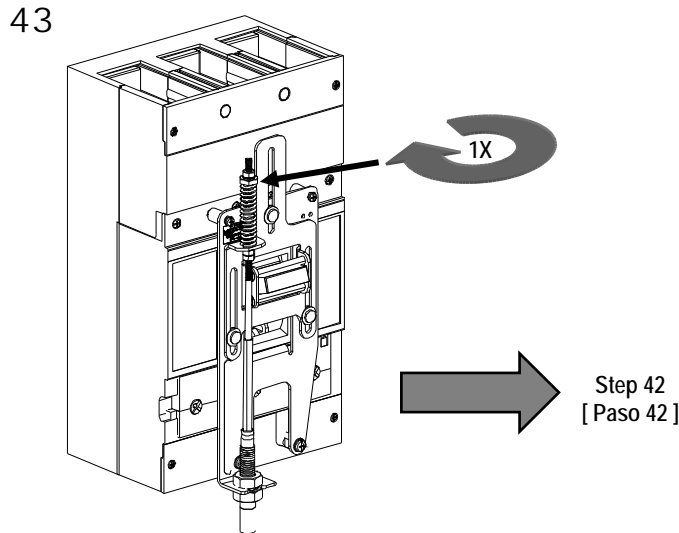

	⚠ Danger	⚠ Peligro	⚠ Danger
	Hazardous Voltage. Will cause death or serious injury.	Tensión peligrosa. Puede causar la muerte o lesiones graves.	Tension dangereuse. Danger de mort ou risque de blessures graves.
	Turn off and lock out all power supplying this device before working on this device. Replace all covers before power supplying this device is turned on.	Desenergice totalmente antes de instalar o darle servicio. Reemplace todas las barreras y cubiertas antes de energizar el interruptor.	Couper l'alimentation de l'appareil et barrer avant de travailler. Remplacez tous les couverts avant que l'alprovisionnement de pouvoir soit alimenté.

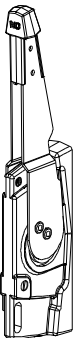
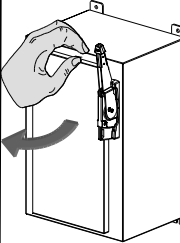

	⚠ Danger	⚠ Peligro	⚠ Danger
	Hazardous Voltage. Will cause death or serious injury.	Tensión peligrosa. Puede causar la muerte o lesiones graves.	Tension dangereuse. Danger de mort ou risque de blessures graves.
	Turn off and lock out all power supplying this device before working on this device. Replace all covers before power supplying this device is turned on.	Desenergice totalmente antes de instalar o darle servicio. Reemplace todas las barreras y cubiertas antes de energizar el interruptor.	Couper l'alimentation de l'appareil et barrer avant de travailler. Remplacez tous les couverts avant que l'approvisionnement de pouvoir soit alimenté.

Test: Door Latch
[Prueba: Seguro de la Puerta]

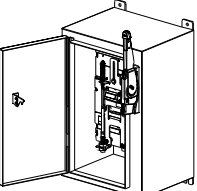
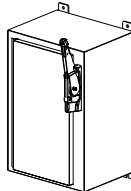
45

		Result [Resultado]		Step [Paso]
		Open [Abierta]	Closed [Cerrados]	
OFF/O  ON/I	5 lbf [22 N]			47
				46

46

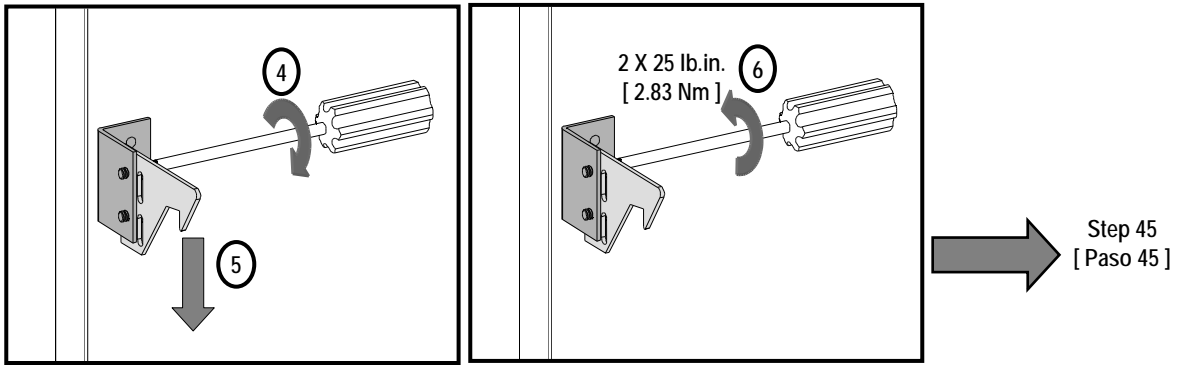

47

		Result [Resultado]		Step [Paso]
		Open [Abierta]	Closed [Cerrados]	
ON / I OFF / O	5 lbf [22 N]			48

48

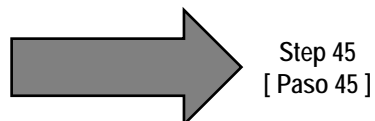
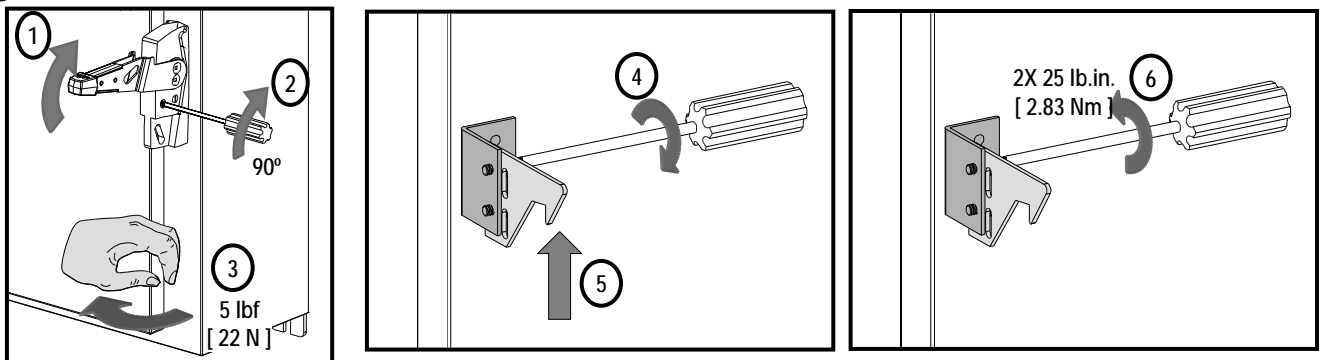



⚠ Danger

Hazardous Voltage.
Will cause death or serious injury.

⚠ Peligro

Tensión peligrosa.
Puede causar la muerte o lesiones graves.

⚠ Danger

Tension dangereuse.
Danger de mort ou risque de blessures graves.



Turn off and lock out all power supplying this device before working on this device.
Replace all covers before power supplying this device is turned on.

Desenergice totalmente antes de instalar o darle servicio.
Reemplace todas las barreras y cubiertas antes de energizar el interruptor.

Couper l'alimentation de l'appareil et barrer avant de travailler.
Remplacez tous les couverts avant que l'alimentation de pouvoir soit alimenté.

**Option:
[Opción:]**

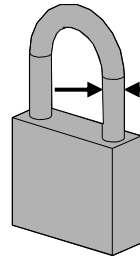
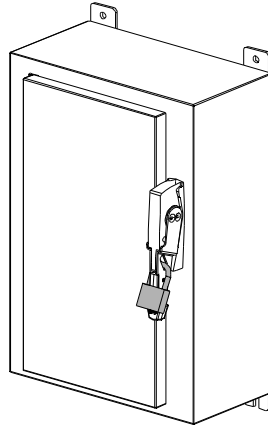

Ø.12" - .32" Max
[Ø3 - 8mm Max.]

1 - 3X

**Option:
[Opción:]**

Padlock ON / I
[Candado ON / I]

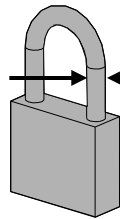

Ø.16" - .32"
[Ø4 - 8]

1X

