

Malleable with/without Cover & Gasket

Images

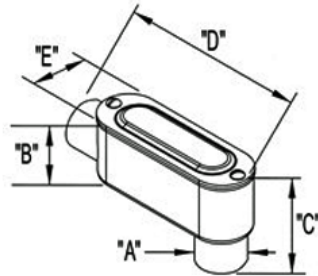

[Download Photo Image](#)

[Download Dimensional Image](#)

Dimension A in Inches: 3.33
Dimension B in Inches: 4.75
Dimension C in Inches: 6.14
Dimension D in Inches: 13.81
Dimension E in Inches: 4.32

Application

For use with 2-1/2" rigid metallic raceways. Allows access to conductors for pulling and splicing. Suitable for use in Wet Locations. Nema 4 rated. Includes stamped steel cover and neoprene gasket. 142 cubic inch volume. Max conductor fill is 3-300MCM

Product Information

Material: Malleable Iron Conduit Body, Zinc Coated Steel Cover, Neoprene Gasket
Finish: Zinc Plated Aluminum Enameled

Certifications & Codes:

Federal Specification Number: A-A-50563A
NEMA Standard: FB-1
UL File Number: E11077
UL Standard: UL514B
UNSPSC: 39131708

Catalog ID: LB-67CG

UPC Number: 78174706177

Description: 2-1/2 inch malleable iron LB conduit body with steel cover and neoprene gasket. Constructed with NPT "tapered" hubs.

Application: For use with 2-1/2" rigid metallic raceways. Allows access to conductors for pulling and splicing. Suitable for use in Wet Locations. Nema 4 rated. Includes stamped steel cover and neoprene gasket. 142 cubic inch volume. Max conductor fill is 3-300MCM

Trade Size: 2-1/2"

Std Pkg Qty: 1

Unit Qty: --