

5L

FVN Series Fluorescent Luminaires

Cl. I, Div. 2, Groups A, B, C, D
 Cl. I, Zone 2, Group IIC
 Cl. II, Div. 1, Groups F, G
 Cl. III & Simultaneous Presence

Wet Locations
 NEMA 3, 3R

Applications:

FVN Luminaires are ideal for use:

- In areas made hazardous by the abnormal conditions resulting in the presence of flammable vapors or gases and combustible dusts as defined by the National Electrical Code®
- Where broken lamps would damage machinery or processes, or harm people working in the area
- In areas where stringent sanitation requirements exist

Features:

- One-piece seamless sheet steel housing with welded end caps keeps dirt, dust and moisture away from ballast and lamps; easy to clean
- A silicone rubber gasket provides a dust-tight seal between the lens/frame assembly and housing
- Lens/frame assembly is hinged and wireway cover is held by safety chain for ease of lamp replacement and maintenance
- Polyester powder coat finish provides high reflectance and corrosion resistance for long life and dependable service
- Two 1/2" NPT pendant hubs and two 1/2" NPT thru-feed end hubs are standard
- Electronic ballast is standard

Certifications and Compliances:

- NEC and CEC:
 - Class I, Division 2, Groups A, B, C, D
 - Class I, Zone 2, Group IIC
 - Class II, Division 1, Groups F, G
 - Class III
 - Simultaneous Presence (Cl. I and Cl. II)
- UL Standards:
 - 844 Hazardous (Classified) Areas
 - 1598 Luminaires
- CSA Standards:
 - C22.2 No. 137



Standard Materials:

- Luminaire housing – 20-gauge seamless sheet steel
- Lens/frame assembly – stainless steel
- Glass – 3/16" tempered
- Suspension flanges – seamless sheet steel
- Gaskets – silicone
- Lampholders – white thermoset plastic
- Clamps – stainless steel

Standard Finishes:

- Reflector housings – corrosion-resistant white polyester powder coat
- Lens/frame – natural

Dimensions

In Inches:

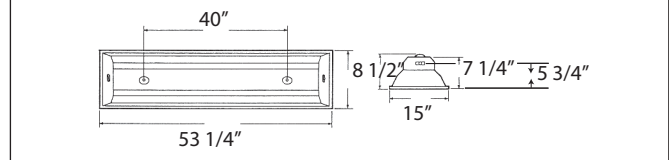

Ordering Information (Lamps not supplied):

Lamp Watts	Line Voltage/Hertz	Lamp Type	Hub Size	2-Lamp Cat. #
32	120-277/50-60	T8	1/2 NPT	FVN4232TG/UNV

Temperature Performance Data: (Based on 40°C ambient)

Lamp	Cl. I, Div. 2 & Zone 2		Class II		Simultaneous Presence		Supply Wire
	2-Lamp	2-Lamp	2-Lamp	2-Lamp	2-Lamp		
32W	T5	T6	T6	T6	T4	60°C	

Photometric Data:

- Complete photometrics can be found at www.crouse-hinds.com/photometrics