

Miscellaneous Standard Grade Switches

Door Operated Canopy Switch Assemblies

FEATURES

- Wide variety of uses in doorways or other entries.
- 6" (152.4mm) wire leads with female disconnects: #18 AWG – FT1, rated 105°C, stripped 0.50" (12.7mm).
- Brass-toned faceplate measures just 1.25" (31.8mm) wide for convenient installation.
- Includes steel switch box with 4 knockouts.
- Supplied with 4 - #6 x 0.625" (15.875mm) flathead wood screws for box mounting, 2 - #6-32 x 0.50"(12.70mm) brass-plated device mounting screws.

Door Operated Canopy Switch Assemblies

10A, 125/277V/AC; Wire Leads

Description	Switch Color	Catalog No.
1/3 HP Push Button Momentary Contact, Single-Pole, On When Door Open	White	□ 1664

 Listed to UL1054, file no. E216737



1664

Door Operated Canopy Switch Assemblies

10A, 125/250/277V/AC; Wire Leads

Description	Switch Color	Catalog No.
1/3 HP Push Button Momentary Contact, Single-Pole, Off When Door Open	Black	□ 1665

 Listed to UL1054, file no. E216737



1665

Miscellaneous Standard Grade Switches

Feed-Through Cord Switches



FEATURES

- Insulation displacement terminals eliminate need for stripping insulation from cord conductors.
- For in-line, On/Off switching.

Feed-Through Cord Switches

3A, 120V/AC; Insulation Displacement Terminals

Description	Color Suffix	Catalog No.	
Feed-Through Cord Switch for #18 AWG SPT-1 Cord, On-Off Sequence	B, V, W	□ 410	
Feed-Through Cord Switch for Flat or Round Cords, On-Off Sequence; Fits the Following Cord Types: #18/2 SPT-1, SPT2 or HPN Cord; #16/2 SPT-1, SPT2 or HPN Cord; Round Type SVT Cord (max. dia. 9/32", 7.14mm)	B, V, W	□ 933	•

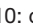
   410: cULus Listed to UL20, file no. E208228

   933: Listed to UL20, file no. E47968; CSA certified to C22.2, no. 111; NOM certified



410



933

Color Ordering Information: For ordering devices, include Cat. No. followed by the color code: B (Brown), V (Ivory), W (White)

Dimensional Information: B-60

Specification Information: Please visit www.cooperwiringdevices.com

 **NAFTA Compliant:** See page F-21

Switches

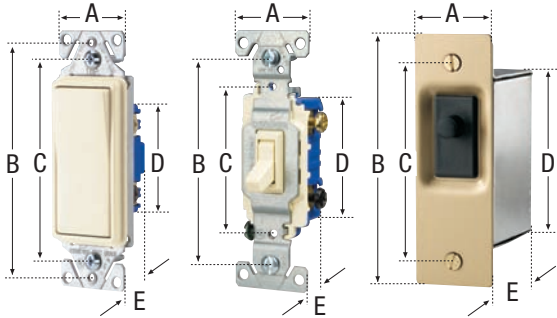

Family	A	B	C	D	E
Decorator Standard Grade, Single-Pole & 3-Way	1.44" (36.6mm)	3.81" (96.8mm)	3.28" (83.3mm)	2.74" (69.6mm)	0.97" (24.6mm)
Decorator Standard Grade, 4-Way	1.44" (36.6mm)	3.81" (96.8mm)	3.28" (83.3mm)	2.60" (66.1mm)	1.18" (30.0mm)
Heavy Duty Grade Toggle	1.31" (33.3mm)	3.28" (83.3mm)	2.38" (60.5mm)	2.00" (50.8mm)	1.05" (26.7mm)
Standard Grade Toggle	1.31" (33.3mm)	3.28" (83.3mm)	2.38" (60.5mm)	2.13" (54.1mm)	0.88" (22.4mm)
Standard Grade Toggle, Less Ears	0.75" (19.1mm)	3.28" (83.3mm)	2.38" (60.5mm)	2.13" (54.1mm)	0.88" (22.4mm)
CO/ALR Standard Grade Toggle	1.31" (33.3mm)	3.28" (83.3mm)	2.38" (60.5mm)	2.13" (54.1mm)	0.88" (22.4mm)
Door Operated Canopy Switch Assembly	1.25" (31.8mm)	3.94" (100.1mm)	3.13" (79.5mm)	2.63" (66.8mm)	1.25" (31.8mm)

Circuit Control Switches



Cat. No.	A	B	C
452	0.50" (12.7mm)	0.88" (22.4mm)	0.53" (13.5mm)

Feed-Through Cord Switches

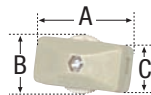

Cat. Nos.	A	B	C
410	1.35" (34.5mm)	0.91" (23.1mm)	0.55" (14.0mm)
933	2.49" (63.4mm)	1.47" (36.7mm)	1.25" (31.6mm)

Combination Devices

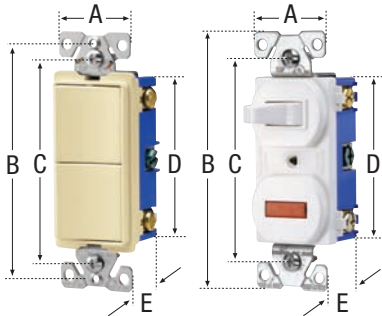

Family	A	B	C	D	E
Decorator Combination	1.30" (33.0mm)	3.81" (96.8mm)	3.28" (83.3mm)	2.65" (67.3mm)	1.08" (27.4mm)
Traditional Combination	1.30" (33.0mm)	4.19" (106.4mm)	3.28" (83.3mm)	2.65" (67.3mm)	1.08" (27.4mm)
Nightlight Combination	1.30" (33.0mm)	3.81" (96.8mm)	3.28" (83.3mm)	2.65" (67.3mm)	1.08" (27.4mm)

Duplex Receptacles

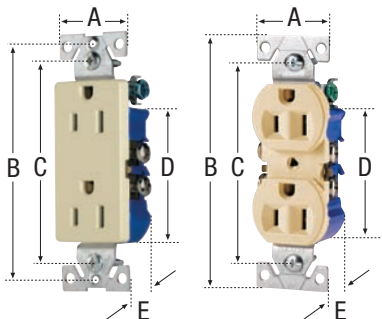

Family or Cat. No.	A	B	C	D	E
Heavy Duty Grade Tamper Resistant	1.24" (31.5mm)	4.00" (101.6mm)	3.23" (82.0mm)	2.63" (66.8mm)	1.04" (26.4mm)
Decorator Standard Grade	1.30" (33.0mm)	3.81" (96.8mm)	3.28" (83.3mm)	2.12" (53.8mm)	0.69" (17.5mm)
Standard Grade, except 298	1.31" (33.3mm)	4.19" (106.4mm)	3.28" (83.3mm)	2.63" (66.8mm)	0.69" (17.5mm)
298	1.31" (33.3mm)	4.19" (106.4mm)	3.28" (83.3mm)	2.63" (66.8mm)	0.74" (18.8mm)
CO/ALR Standard Grade	1.38" (35.1mm)	4.06" (103.1mm)	3.28" (83.3mm)	2.61" (66.3mm)	0.71" (18.0mm)