



# Metallics

An **AMERICAN** Source For Premier  
and Innovative Fasteners and Anchors

## HAMMER DRIVE WEDGE ANCHOR

The following Specification Sheet applies to all **Hammer Drive Wedge Anchors** in our **JHW series**.



### **Metallics**

229 Cross Street  
Bristol, CT 06010

[www.metallics.us](http://www.metallics.us)

Phone: 860 589-4186 Toll Free: 800 243-8272

Fax: 860 584-1008 Toll Free Fax: 800 831-9358



# Metallics

An **AMERICAN** Source For Premier  
and Innovative Fasteners and Anchors

## RECOMMENDED EMBEDMENT

Anchor Size Dia. x Length	Thread Length (In.)	Maximum Thickness Fastened	Drill Size
1/4 x 1 3/4	5/8	3/8	1/4
1/4 x 2 3/8	3/4	1	1/4
5/16 x 2	1/2	1/2	5/16
5/16 x 2 3/4	1 1/8	1 1/4	5/16
5/16 x 4	1 1/8	2 1/2	5/16
3/8 x 2 3/8	7/8	3/4	3/8
3/8 x 3 1/2	1 1/8	1 7/8	3/8
3/8 x 5	1 1/8	3 3/8	3/8
1/2 x 2 3/4	7/8	3/4	1/2
1/2 x 3 1/2	1	1 1/2	1/2
1/2 x 4 3/4	1 3/4	2 3/4	1/2
1/2 x 6	1 7/8	4	1/2
5/8 x 4	1 1/4	1 5/8	5/8
5/8 x 4 3/4	1 1/4	2 3/8	5/8
5/8 x 6	1 1/4	3 5/8	5/8
3/4 x 5	1 3/4	2 1/4	3/4
3/4 x 6	1 3/4	3 1/4	3/4

### Metallics

229 Cross Street  
Bristol, CT 06010

[www.metallics.us](http://www.metallics.us)

Phone: 860 589-4186 Toll Free: 800 243-8272

Fax: 860 584-1008 Toll Free Fax: 800 831-9358

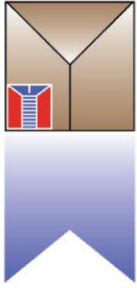

# Metallics

An **AMERICAN** Source For Premier  
and Innovative Fasteners and Anchors

## RECOMMENDED SPACING

Anchor Diameter	Embedment	Minimum Spacing between Anchors	Minimum Edge Distance
1/4"	1"	3 1/2	1 3/4
1/4"	1 3/4"	3 1/2	1 3/4
5/16"	1 1/8"	3 1/2	1 3/4
5/16"	2 1/8"	4	2
3/8"	1 1/4"	4 3/8	2 3/16
3/8"	2 1/2"	5	2 1/2
1/2"	1 1/2"	5 1/4	5 5/8
1/2"	3"	6	3
5/8"	1 3/4"	6 1/8	3 1/16
5/8"	3 1/4"	7 1/2	3 3/4
3/4"	2"	7	3 1/2
3/4"	3 1/2"	9	4 1/2

Anchor spacing recommendations serve only as a guideline. Spacing will vary as the density of the masonry material changes.

## PULL-OUT/SHEAR TEST RESULTS

Diameter	2000 PSI CONCRETE			4000 PSI CONCRETE	
	Tension		Shear	Tension	
	Min. Embed.	Max. Embed.	Min. Embed.	Min. Embed.	Max. Embed.
1/4"	(1") 900	(1 1/2") 1000	(1") 1600	(1") 1300	(1 1/2") 1400
5/16"	(1 1/4") 1400	(1 7/8") 1500	(1 1/4") 3000	(1 1/4") 2100	(1 7/8") 2400
3/8"	(1 1/2") 2200	(2 1/4") 2800	(1 1/2") 3400	(1 1/2") 3200	(2 1/4") 3700
1/2"	(2") 3600	(3") 4200	(2") 7200	(2") 5600	(3") 5700
5/8"	(2 1/2") 5400	(3 3/4") 6600	(2 1/2") 9200	(2 1/2") 7500	(3 3/4") 10,400
3/4"	(3") 7500	(4 1/2") 9900	(3") 13,500	(3") 9500	(4 1/2") 13,400

A safety factor of 4:1, or 25% of ultimate, should be used. Critical applications (vibratory loads, overhead installations, etc.) may require a safety factor of as much as 10:1, or more.

### Metallics

229 Cross Street  
Bristol, CT 06010

[www.metallics.us](http://www.metallics.us)

Phone: 860 589-4186 Toll Free: 800 243-8272

Fax: 860 584-1008 Toll Free Fax: 800 831-9358

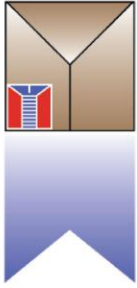

# Metallics

An **AMERICAN** Source For Premier  
and Innovative Fasteners and Anchors

## Installation Procedure

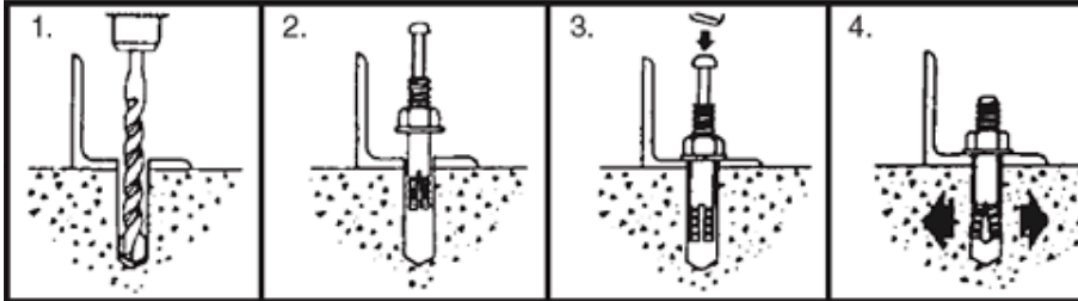

1. Drill hole of sufficient depth using same diameter DFS Bit as anchor being installed.
2. Turn nut on anchor as required. May be flush with top or turned on fully to provide stud finish.
3. With nut, washer, and set-pin in place, insert anchor into hole.
4. Using a proper sized hammer, set pin with several sharp and square strikes on head of pin until pin is flush with top of anchor. Anchor is now properly set.
5. No need to torque nut to set anchor.

### Metallics

229 Cross Street  
Bristol, CT 06010

[www.metallics.us](http://www.metallics.us)

Phone: 860 589-4186 Toll Free: 800 243-8272

Fax: 860 584-1008 Toll Free Fax: 800 831-9358