



# Metallics

An **AMERICAN** Source For Premier  
and Innovative Fasteners and Anchors

## ROD COUPLER/PIPE HANGING ANCHOR

The following Specification Sheet applies to all **Rod Coupler/Pipe Hanging Anchors** in our **PD series**.

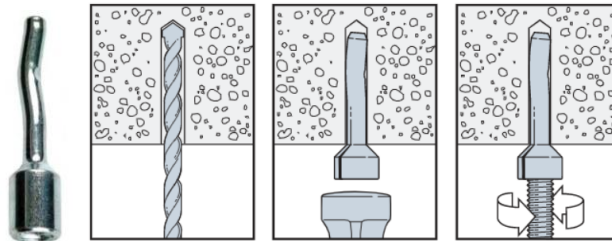

Carbon-Steel Crimp Drive Allowable Tension and Shear Loads  
in Normal-Weight Concrete



Size (in.)	Drill Bit Diameter (in.)	Embed. Depth (in.)	Minimum Spacing (in.)	Minimum Edge Distance (in.)	Tension Load	
					$f'_c \geq 2,000$ psi Concrete	$f'_c \geq 4,000$ psi Concrete
					Allowable Load (lb.)	Allowable Load (lb.)
1/4	3/16	1 1/4	3	3	145	250
3/8	1/4	1 1/2	4	4	265	600

1. The allowable loads listed are based on a safety factor of 4.0.
2. The minimum concrete thickness is 1 1/2 times the embedment depth.
3. Allowable loads may be linearly interpolated between concrete strengths listed.
4. For rod coupler, mechanical and plumbing design codes may prescribe lower allowable loads; verify with local codes.

### Metallics

229 Cross Street  
Bristol, CT 06010

[www.metallics.us](http://www.metallics.us)

Phone: 860 589-4186 Toll Free: 800 243-8272

Fax: 860 584-1008 Toll Free Fax: 800 831-9358



# Metallics

An **AMERICAN** Source For Premier  
and Innovative Fasteners and Anchors

## Carbon-Steel Crimp Drive Allowable Tension and Shear Loads in Sand-Lightweight Concrete over Metal Deck



Size (in.)	Drill Bit Diameter (in.)	Embed. Depth (in.)	Minimum Spacing (in.)	Minimum Edge Distance (in.)	Tension Load (Install in Concrete)	Tension Load (Install through Metal Deck)
					$f'_c \geq 3,000$ psi Concrete	$f'_c \geq 3,000$ psi Concrete
					Allowable Load (lb.)	Allowable Load (lb.)
1/4	3/16	1 1/4	4	4	115	85
3/8	1/4	1 1/2	5	5	300	280

1. The allowable loads listed are based on a safety factor of 4.0.
2. The minimum concrete thickness is 1 1/2 times the embedment depth.
3. Anchors may be installed off-center in the flute, up to 1" from the center of flute.
4. Anchor may be installed in either upper or lower flute.
5. Deck profile shall be 3" deep, 20-gauge minimum.
6. For rod coupler, mechanical and plumbing design codes may prescribe lower allowable loads; verify with local codes.

### Metallics

229 Cross Street  
Bristol, CT 06010

[www.metallics.us](http://www.metallics.us)

Phone: 860 589-4186 Toll Free: 800 243-8272

Fax: 860 584-1008 Toll Free Fax: 800 831-9358