

Generic Product Comparison

Conduit Bodies

Aluminum Conduit Bodies

Threaded for Rigid Conduit and IMC
Copper-Free Aluminum



TYPE C-A					
Trade Size (inches)	Appleton	Crouse-Hindst†	Killark	Red Dot	O-Z/Gedney
½	C50-A	C19	OC-1	AC-1	C-50A
¾	C75-A	C29	OC-2	AC-2	C-75A
1	C100-A	C39	OC-3	AC-3	C-100A
1¼	C125-A	C49	OC-4	AC-4	C-125A
1½	C150-A	C59	OC-5	AC-5	C-150A
2	C200-A	C69	OC-6	AC-6	C-200A
2½	C250-A	C789	OC-7	AC-7*	C-250A
3	C300-A	C889	OC-8	AC-8*	C-300A
3½	C350-A	C989	OC-9	AC-9*	C-350A
4	C400-A	C1089	OC-10	AC-10*	C-400A



TYPE LB-A					
Trade Size (inches)	Appleton	Crouse-Hindst†	Killark	Red Dot	O-Z/Gedney
½	LB50-A	LB19	OLB-1	ALB-1	LB-50A
¾	LB75-A	LB29	OLB-2	ALB-2	LB-75A
1	LB100-A	LB39	OLB-3	ALB-3	LB-100A
1¼	LB125-A	LB49	OLB-4	ALB-4	LB-125A
1½	LB150-A	LB59	OLB-5	ALB-5	LB-150A
2	LB200-A	LB69	OLB-6	ALB-6	LB-200A
2½	LB250-A	LB789	OLB-7	ALB-7*	LB-250A
3	LB300-A	LB889	OLB-8	ALB-8*	LB-300A
3½	LB350-A	LB989	OLB-9	ALB-9*	LB-350A
4	LB400-A	LB1089	OLB-10	ALB-10*	LB-400A

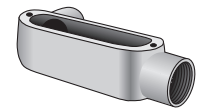

TYPE LL-A					
Trade Size (inches)	Appleton	Crouse-Hindst†	Killark	Red Dot	O-Z/Gedney
½	LL50-A	LL19	OLL-1	ALL-1	LL-50A
¾	LL75-A	LL29	OLL-2	ALL-2	LL-75A
1	LL100-A	LL39	OLL-3	ALL-3	LL-100A
1¼	LL125-A	LL49	OLL-4	ALL-4	LL-125A
1½	LL150-A	LL59	OLL-5	ALL-5	LL-150A
2	LL200-A	LL69	OLL-6	ALL-6	LL-200A
2½	LL250-A	LL789	OLL-7	ALL-7	LL-250A
3	LL300-A	LL889	OLL-8	ALL-8	LL-300A
3½	LL350-A	LL989	OLL-9	ALL-9	LL-350A
4	LL400-A	LL1089	OLL-10	ALL-10	LL-400A

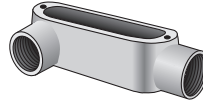

TYPE LR-A					
Trade Size (inches)	Appleton	Crouse-Hindst†	Killark	Red Dot	O-Z/Gedney
½	LR50-A	LR19	OLR-1	ALR-1	LR-50A
¾	LR75-A	LR29	OLR-2	ALR-2	LR-75A
1	LR100-A	LR39	OLR-3	ALR-3	LR-100A
1¼	LR125-A	LR49	OLR-4	ALR-4	LR-125A
1½	LR150-A	LR59	OLR-5	ALR-5	LR-150A
2	LR200-A	LR69	OLR-6	ALR-6	LR-200A
2½	LR250-A	LR789	OLR-7	ALR-7*	LR-250A
3	LR300-A	LR889	OLR-8	ALR-8*	LR-300A
3½	LR350-A	LR989	OLR-9	ALR-9*	LR-350A
4	LR400-A	LR1089	OLR-10	ALR-10*	LR-400A

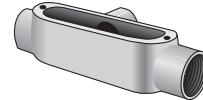

TYPE T-A					
Trade Size (inches)	Appleton	Crouse-Hindst†	Killark	Red Dot	O-Z/Gedney
½	T50-A	T19	OT-1	AT-1	T-50A
¾	T75-A	T29	OT-2	AT-2	T-75A
1	T100-A	T39	OT-3	AT-3	T-100A
1¼	T125-A	T49	OT-4	AT-4	T-125A
1½	T150-A	T59	OT-5	AT-5	T-150A
2	T200-A	T69	OT-6	AT-6	T-200A
2½	T250-A	T789	OT-7	AT-7*	T-250A
3	T300-A	T889	OT-8	AT-8*	T-300A
3½	T350-A	T989	OT-9	AT-9*	T-350A
4	T400-A	T1089	OT-10	AT-10*	T-400A



TYPE TB-A					
Trade Size (inches)	Appleton	Crouse-Hindst†	Killark	Red Dot	O-Z/Gedney
½	TB50-A	TB19	OTB-1	--	TB-50A
¾	TB75-A	TB29	OTB-2	--	TB-75A
1	TB100-A	TB39	OTB-3	--	TB-100A
1¼	TB125-A	TB49	OTB-4	--	TB-125A
1½	TB150-A	--	OTB-5	--	TB-150A
2	TB200-A	--	OTB-6	--	TB-200A

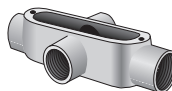

TYPE X-A					
Trade Size (inches)	Appleton	Crouse-Hindst†	Killark	Red Dot	O-Z/Gedney
½	X50-A	X19	OX-1	--	X-50A
¾	X75-A	X29	OX-2	--	X-75A
1	X100-A	X39	OX-3	--	X-100A
1¼	--	--	OX-4	--	X-125A
1½	--	--	OX-5	--	X-150A
2	--	--	OX-6	--	X-200A

* Red-Dot Shipped with diecast Cover † Crouse-Hinds not interchangeable with other manufacturer's covers and gaskets.