

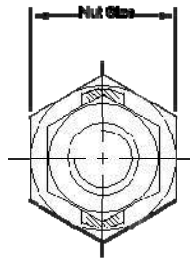

Service Post Connectors

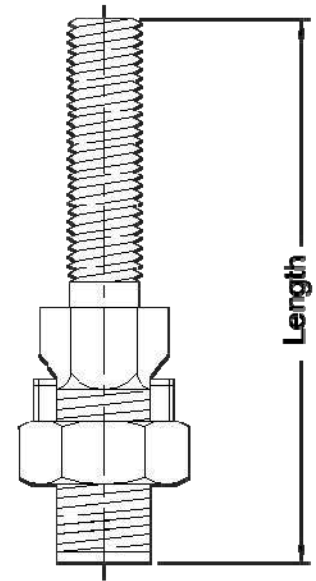

- Used to Ground Two Wire to Steel Structures, Transformers, Fence Posts, Steel Bar, or Plate
- High Strength Electrolytic Copper
- UL 467 Listed for Direct Burial & Grounding/Bonding Applications in Earth or Concrete
- cULus Listed

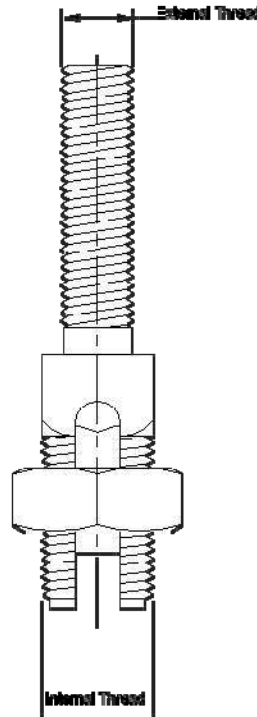

Part No.	Nut Size	Length	External Thread	Internal Thread	Conductor Size	
					Min	Max
90380	.37	1.81	1/4" x 20 UNC	3/8" x 24 UNF	(2)#14	(2)#8
90381	.43	1.97	1/4" x 20 UNC	7/16" x 20 UNF	(2)#10	(2)#6
90382	.5	2.17	5/16" x 18 UNC	1/2" x 20 UNF	(2)#12	(2)#4
90383	.56	2.38	3/8" x 16 UNC	9/16" x 18 UNF	(2)#12	(2)#2
90384	.68	2.52	1/2" x 13 UNC	1-1/6" x 16 UNF	(2)#2	(2)#1
90385	.75	2.93	1/2" x 13 UNC	3/4" x 16 UNF	(2)#10	(2)1/0
90386	.87	3.15	1/2" x 13 UNC	7/8" x 14 UNF	(2)#10	(2)2/0
90387	1.12	3.76	5/8" x 11 UNC	1-1/8" x 11 UNF	(2)#10	(2)4/0