

- ▶ Fits existing irregular shaped holes in metal studs
- ▶ Alleviates the need to punch holes in metal studs, weakening the structural member
- ▶ Protects wire insulation from abrasion in metal studs
- ▶ Bushing allows smooth wire pulling
- ▶ No tools needed
- ▶ Use these bushings to comply with paragraph 300-4(b)(1) of the 2005 NEC code which states that: "In both exposed & concealed locations where nonmetallic-sheathed cables pass through either factory or field punched, cut, or drilled slots or holes in metal members, the cable shall be protected by bushings or grommets covering all metal edges & securely fastened in the opening prior to installation of the cable"

Dimensions = Inches

Cat. No.	Stud Size	Dimensions				Bag Qty
		A	B	C	D	
21760	2x4	5.67"	2.50"	.505"	1.30"	25

Plastic Knockout Plugs

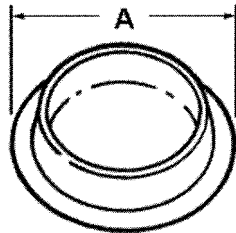

- ▶ To cap knockout holes in box or enclosure

Dimensions = Inches

Cat. No.	Trade Size	Mounting Hole Diameter	A	Bag Qty
21721	1/2"	.85"	1-1/8"	100
21722	3/4"	1.10"	1-1/4"	100
21723	1"	1.35"	1-1/2"	50

Plastic Knockout Plugs - Snap-In

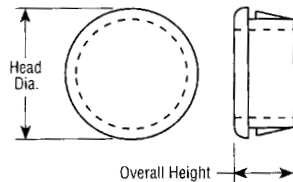

- ▶ Plugs electrical knockouts with finger tip pressure
- ▶ Snap-In Winged Protrusion for Positive Lock
- ▶ Low cost and assures good appearance
- ▶ Less costly & safer than steel snap-in blanks
- ▶ 1/8" maximum steel thickness
- ▶ Made from UL approved Nylon 6/6, 94V-2

Dimensions = Inches

Cat. No.	Mounting Hole Diameter	Head Diameter	Overall Height	Bag Qty
22380	.18 (3/16")	.25"	.23"	10
22382	.31 (5/16")	.47"	.31"	10
22384	.37 (3/8")	.51"	.41"	10
22386	.50 (1/2")	.67"	.41"	10
22388	.63 (5/8")	.78"	.41"	10
22390	.75 (3/4")	.90"	.41"	10
22392	.87 (7/8") (1/2" Trade)	.98"	.44"	10
22394	.98 (1")	1.11"	.44"	10
22396	1.18 (1-1/4") (3/4" Trade)	1.35"	.44"	10
22398	1.50 (1-1/2")	1.67"	.44"	10
22400	1.75 (1-3/4")	1.93"	.44"	10

Sizes listed are actual Diameter (not trade sizes except where noted)

Plastic Pull Caps

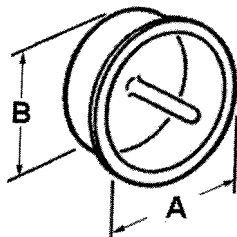

- ▶ Used for capping EMT, IMC & Rigid Conduits and most bushings

Dimensions = Inches

Cat. No.	Trade Size	Dimensions		Box Qty
		A	B	
21712	1/2"	11/16"	5/8"	100
21713	3/4"	15/16"	13/16"	100
21714	1"	1-3/16"	1-1/16"	100
21715	1-1/4"	1-1/2"	1-3/8"	50
21716	1-1/2"	1-3/4"	1-9/16"	25
21717	2"	2-3/16"	2-1/16"	25