



Type: _____ Catalog #: _____
 Project: _____ Contact: _____

4" Low Voltage Recessed Can

New Construction Low Voltage Non-IC

RH4/NLV



DIMENSIONS

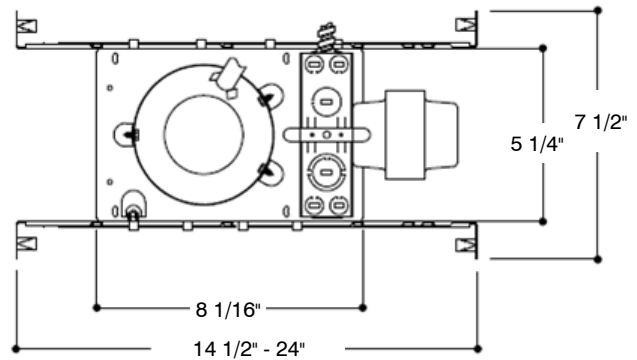
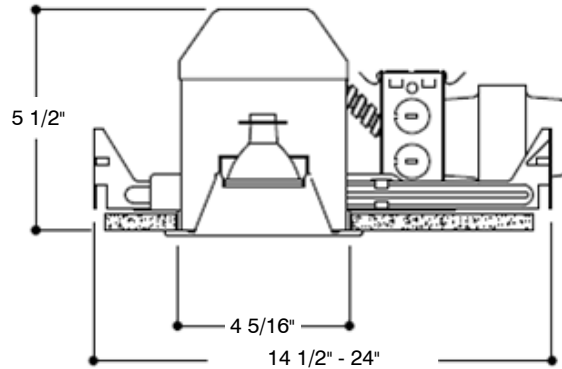

PRODUCT SPECIFICATIONS

Lamp 50 Watt Maximum 12 Volt MR16

Plaster Frame Galvanized steel construction. The housing can be removed from plaster frame to provide access to the junction box.

Transformer 120V Integral magnetic transformer steps line voltage down to lamp operating voltage. For lamps up to 50W. For Electronic Transformer add suffix (E).

Thermal Protector Self resetting thermal protector deactivates fixture if overheating occurs due to improper lamping or misapplied insulation.

INSTALLATION

Bar Hanger Pre-installed nails easily install in regular or engineered lumber. Bar hangers are adjustable from 13-5/8" to 25" and can be repositioned 90 degree on plaster frame.

Junction Box Listed for through branch circuit wiring. Contains seven 7/8" knockouts and four Romex pryouts with strain relief.

LABELS AND LISTINGS

cUL Listed for Damp Location
 cUL Listed for Feed Through



ORDERING INFORMATION

Code: **77667**

Item # **RH4/NLV**

Topaz offers numerous lamp options. Consult your sales rep.

Specifications Subject To Change Without Notice.

Series	Aperture Size	Lamp Orientation	Construction	Lamp Style	# of Lamps	Lamp Wattage	Insulation Contact	Airtight	Voltage	Options
RH= Recessed Housing	3 4 5 6	Blank=Vert H=Hor	Blank=Standard Depth Can N=New R=Remodel S=Shallow SL=Slope SSL=Super Slope	Blank=Incand. C=CFL G=GU LED=LED LV=Low Voltage	1 or 2	Blank=Incand. Insert wattages for CFL, GU and LED	Blank=Non-IC IC=IC	Blank=Non-AT AT=AT	Blank=120 H=120/277V HW=High Wattage (75 Watt)	E=Electronic Transformer



NY Office: 925 Waverly Avenue, Holtsville, NY 11742 • 800-666-2852 • Fax: 631-758-8026
CA Office: 225 Parkside Drive, San Fernando, CA 91340 • 888-551-2852 or 818-838-3123 • Fax: 888-690-2852 or 818-838-3102
FL Office: 2020 West 26th Street, Jacksonville, FL 32209 • 800-338-2852 • Fax: 772-778-5386