



301 Fulling Mill Road, Suite G  
 Middletown, PA 17057  
 Phone (800) 321-2343 / Fax (717) 702-2546  
 www.onqlegrand.com

## IS-0427 Rev. 0

### 1. INTRODUCTION

The On-Q/Legrand Universal IR Target, P/N AC1016 (see **Figure 1**), is replacement for the existing IR Target (P/N F7426) and is designed to be used with both the lyriQ™ Audio Distribution System and the TV Display Interface. In both cases, it is typically used with the On-Q Universal Remote Control (P/N AU1060) to further enhance its functionality (see **Figure 2**).

### 2. DESCRIPTION

The Universal IR Target is sized smaller than a stick of gum, and is designed with two receivers and provided with a piece of double backed adhesive tape for mounting in a variety of locations and positions. The housing is also designed so that the cable may be dressed out in different orientations to enhance its installation flexibility.

### 3. OPERATION

The Universal IR Target can operate in one of three modes for IR signal input, as determined by the position of the slide switch on the side of the base of the target (see **Figure 1**). The three modes are 40KHz, 56KHz and Burst Mode, which is the default mode, designed to work with either 40KHz or 56KHz IR input signals. **Figure 2** shows an example installation. Images from the three Ball Cameras (P/N CM5002-xx) are routed over Cat 5 to the Camera Module (P/N CM1011) in the enclosure. RCA jumpers are then used to connect to the LCD Display Module (P/N CM1010) in the enclosure. Cat 5 cable is again used to connect to the LCD Panel Displays (P/N HA5000-xx) and also to the TV Display Interfaces (P/N HA5201-xx). RCA cables are then used for connection to the homeowner TV. The On-Q Universal Remote Control (P/N AU1060) is used in conjunction with the Universal IR Target (P/N AC1016) to control the TV and which camera image is displayed.

**NOTE:** Figure 2 shows two different orientations for mounting the Universal IR Target.

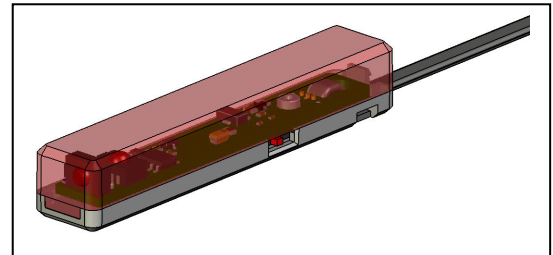

**Figure 1**

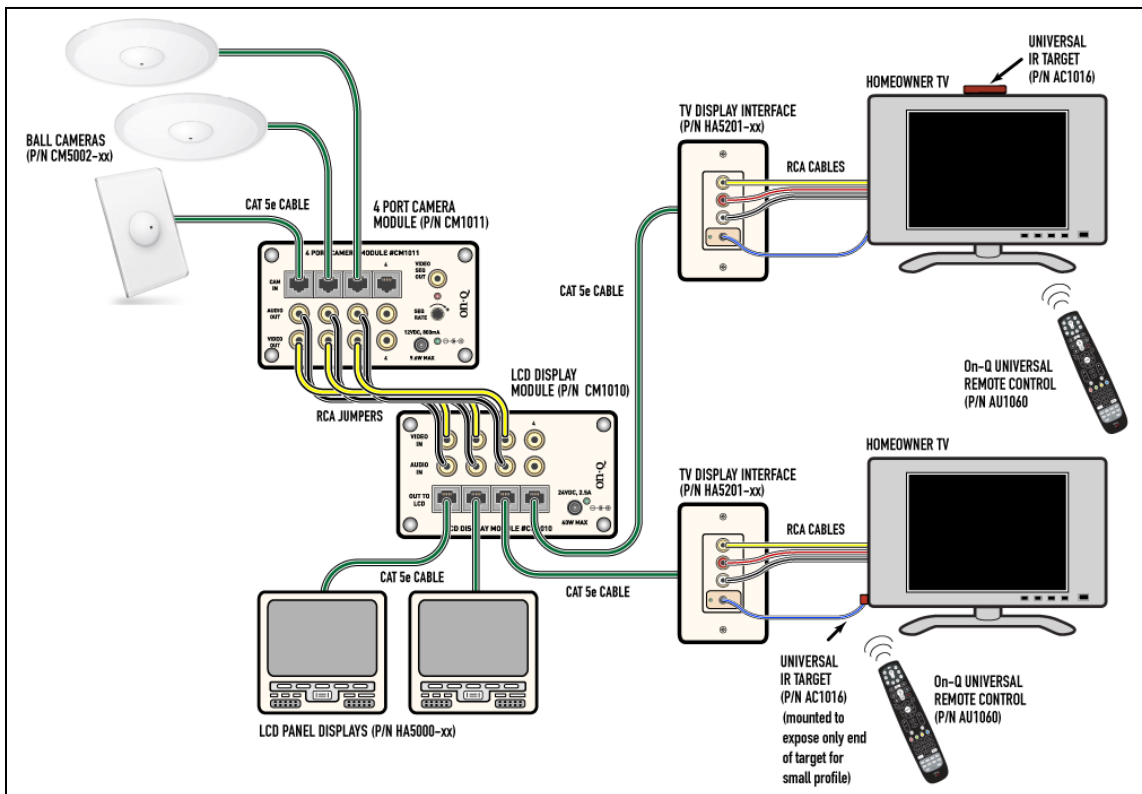

**Figure 2**

### 4. INSTALLATION

As illustrated previously in **Figure 2** the Universal IR Target may be mounted in different orientations. **Figure 3** shows that there are actually two IR receivers to accommodate a more flexible mounting arrangement. **Figure 3** also shows the strain relief plate and screw on the bottom of the IR Target that allows the cable to be oriented out the end (as shown), or out either side.

The small slide switch on the side of the Universal IR Target is used to select 40KHz, 56KHz or Burst mode (default) IR Frequency support. The Universal IR Target's cable is 10' long and terminated with a 3.5mm Stereo Audio style (3 contact) plug.

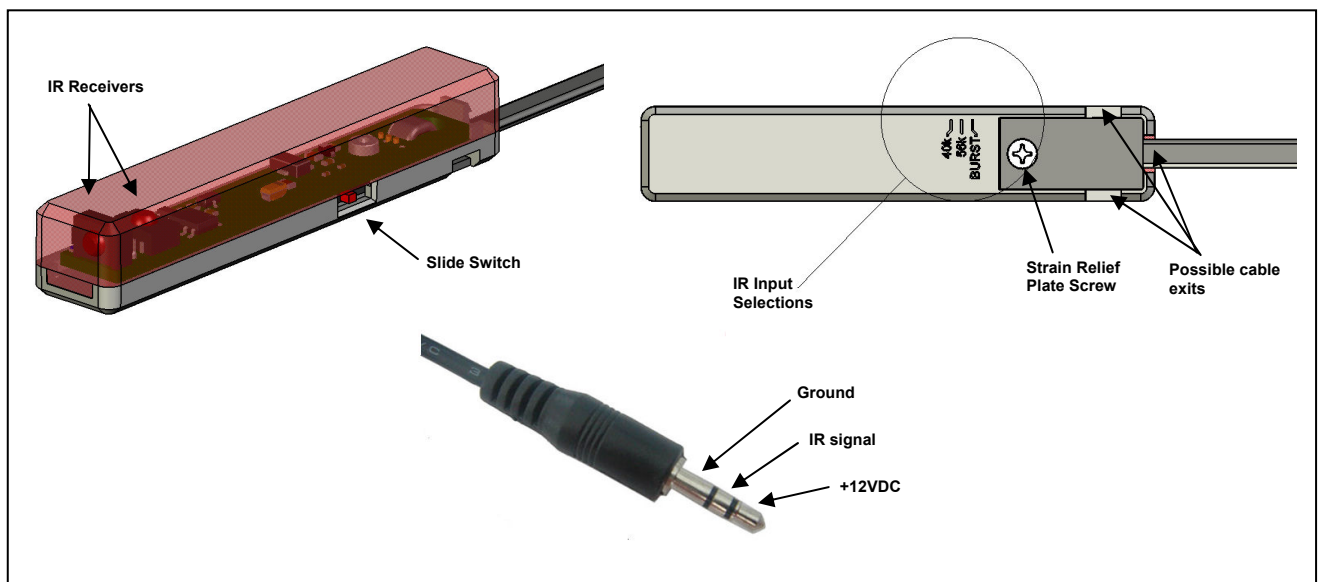

Figure 3