

Kindorf®

Fittings & Hardware
T&B Catalog Number:

B 915
 78599175756
 Active

UPC Number:
Status:
Description:

Two hole Steel Angle Connector with Galv-Krom finish.

Application

Can also be used as side beam connector to suspend 1/2 in. hanger rod.

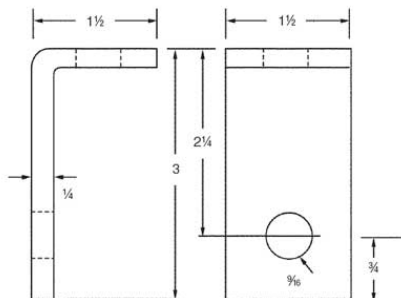

General

Material: Steel
 Finish: Galv-Krom

Dimension Information

Bolt Hole Diameter (inches): 9/16
 Bolt Hole From End (inches): 3/4
 Material Thickness (inches): 1/4

Specifications

3dmodel: Available on Website

Packaging

Package in Units: 50
 T&B Sold in UOM: Each
 T&B Weight Per UOM: 39.8 lbs. per 100

Application Support

Product Brochure-Square Washers: Available on Website
 Product Overview-Metal Framing Systems: Available on Website
 Product Overview-Finishes & Materials: Available on Website
 Product Overview-Fittings & Hardware: Available on Website

Certifications

RoHS Compliance: No

For further technical assistance, please contact us...

Thomas & Betts - USA
 8155 T&B Blvd.
 Memphis, TN 38125
 www.tnb.com

T&B Technical Support
 MS 3B-50
 8155 T&B Blvd.
 Memphis, TN 38125

Hours: 7AM - 6PM CDT
 Monday-Friday
 Phone: (888) 862-3289
 Fax: (901) 252-1321
 Email: techsupport@tnb.com